



**SAVING  
THE BEST  
FOR LAST**

 **CONTACT**  
DEVELOPMENTS





**CONTACT**  
DEVELOPMENTS

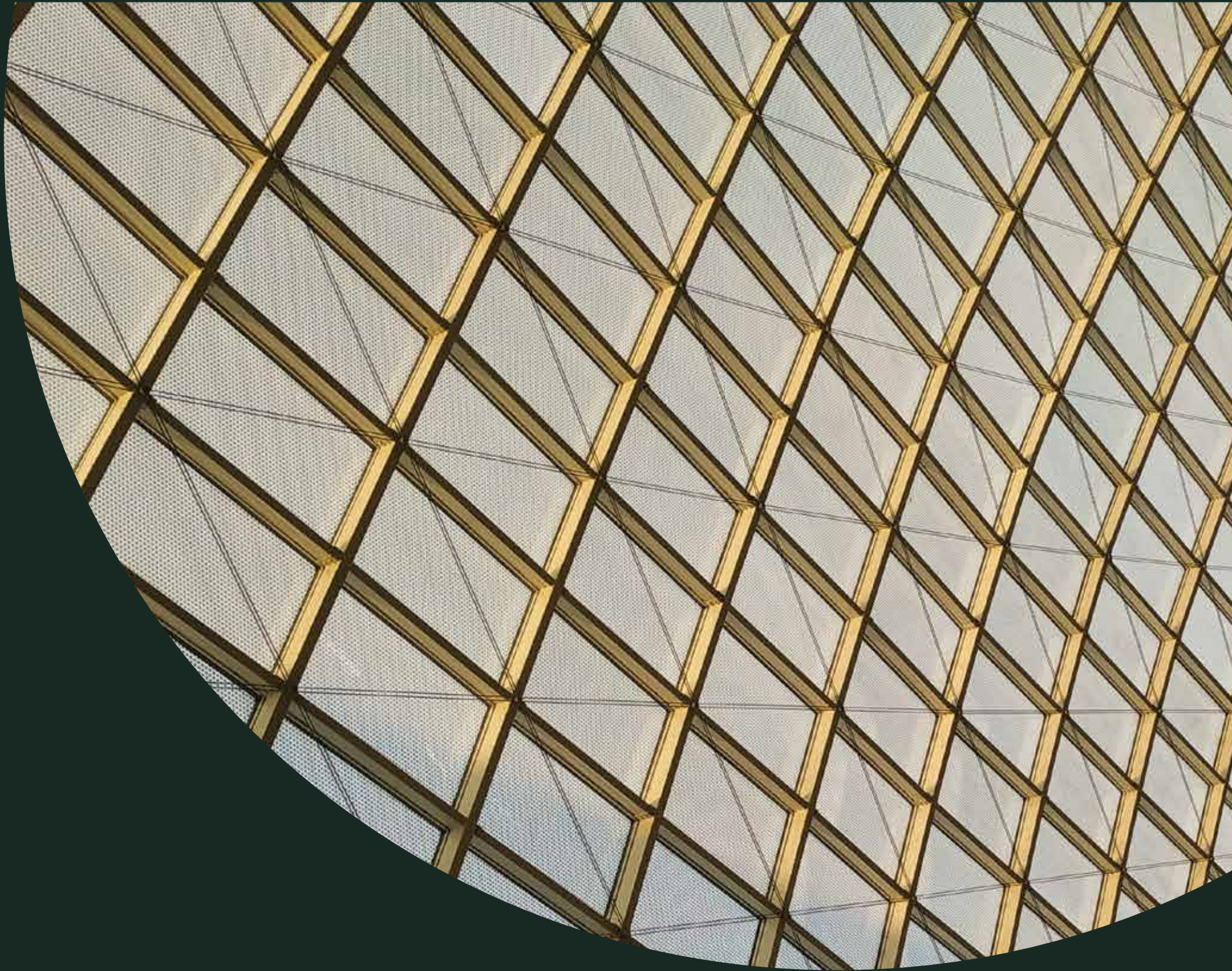

**ABOUT**  
**CONTACT**





Contact is a leading real estate developer founded on a solid foundation of professional experience, spanning 20 years of successes in the fields of construction and development across Egypt and KSA. The company's holistic vision has allowed it to carve a competitive niche for itself in the market, thanks to a comprehensive range of multidisciplinary services, catered around clients' diversified needs. Backed up by highly ranked consultants and a pioneering vision, the company provides businesses with breakthrough consultation and managing strategic plans while offering professional business solutions centered around the real-estate industry to accelerate growth. With an eye on the future and commitment to exceed every expectation, Contact has landed with its expertise in Cairo's New Administrative to introduce Mercury Business Complex in the thriving Downtown area and is currently proud to introduce its latest innovation Cayo Mall.

# A CLOSER LOOK TO JOY



**DOWNTOWN - NEW CAPITAL**





CA  
YO

CONTRACT

RESTAURANT



# SAVING THE BEST FOR LAST

DOWNTOWN - NEW CAPITAL







CA  
10



# STEP INTO THE SPOTLIGHT



DOWNTOWN - NEW CAPITAL



CA  
YO





# VARIOUS ACTIVITIES





**RETAIL**





# FOOD & BEVERAGE





**OUR  
UNIQUE  
LOCATION**





# ( NEW CAPITAL )

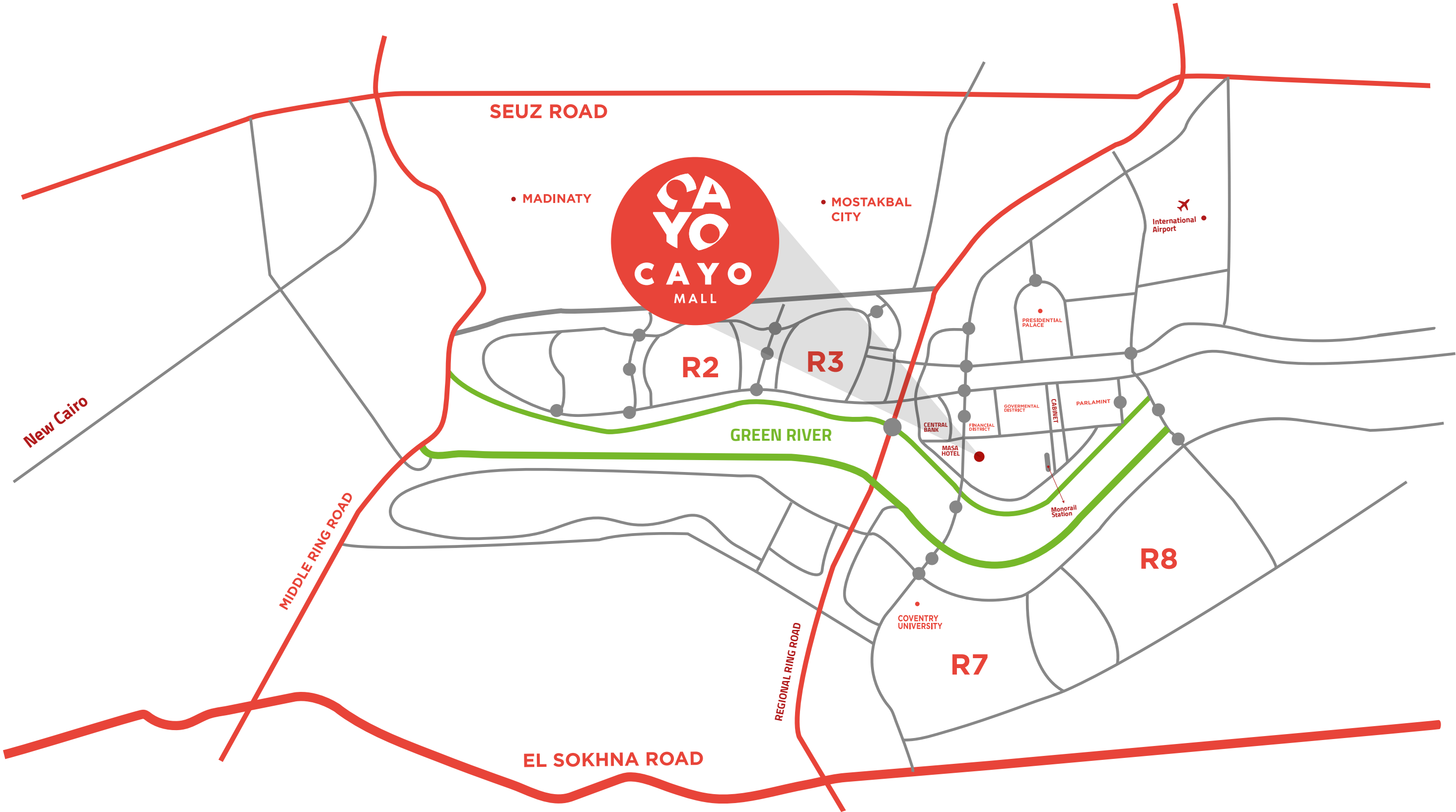



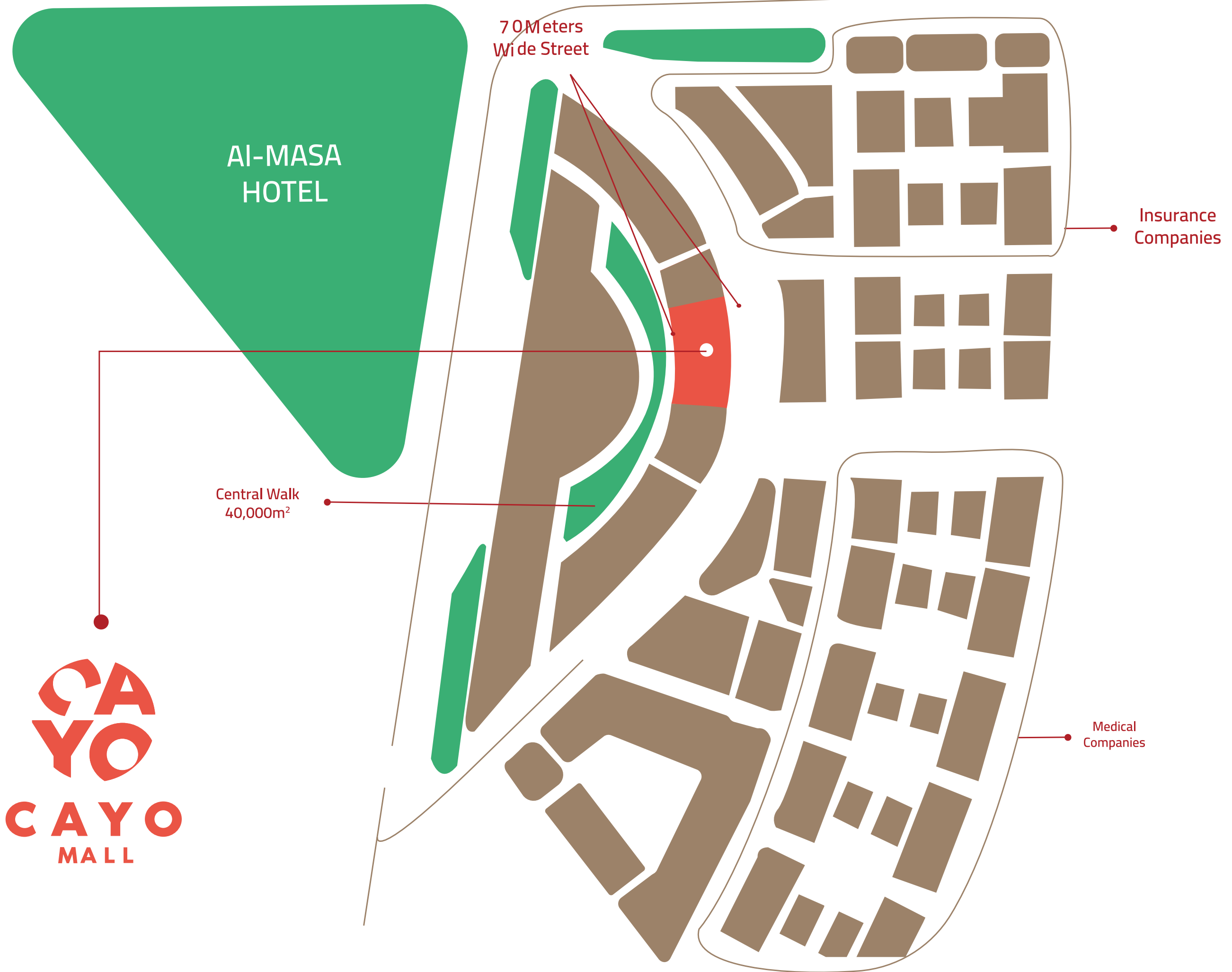

AI-MASA  
HOTEL

70 Meters  
Wide Street

Insurance  
Companies

Central Walk  
40,000m²

Medical  
Companies

**CA  
YO**  
**CAYO**  
MALL



# TOTAL LAND AREA: 7,100M<sup>2</sup>

The impressive land area provides various opportunities for growth in an ever-expansive city as well as a high possibility for attracting new customers and being a prominent commercial venue in an already competitive hub.

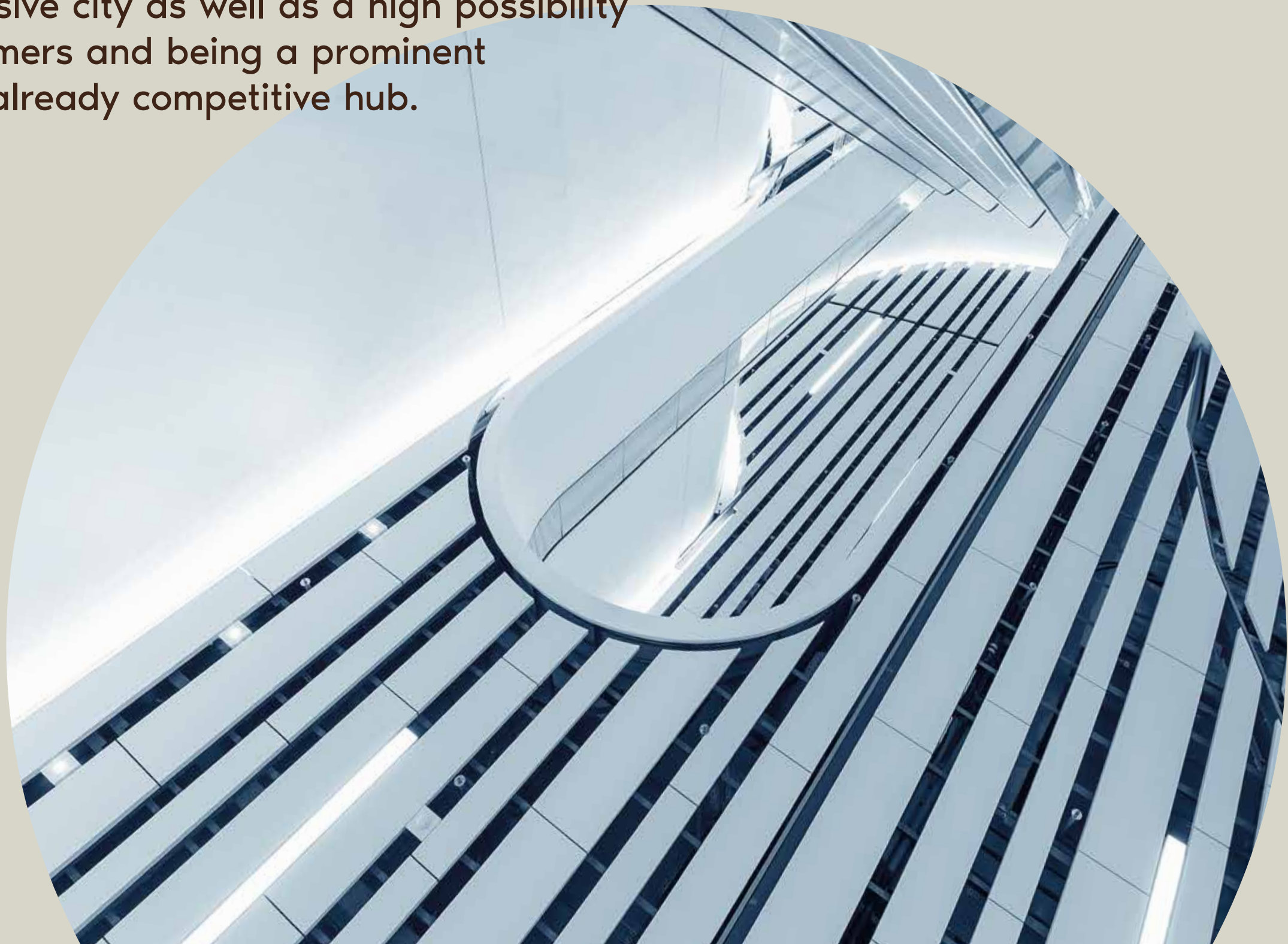





# FLOOR PLANS





# GROUND FLOOR





# GROUND FLOOR OUTDOOR AREA: 4,900M<sup>2</sup>

Incorporating nature into the shopping experience is a beneficial and often overlooked aspect, but with CAYO's vast outdoor area, the earthy and beautiful view of the natural greenery is available every day.





# FIRST FLOOR

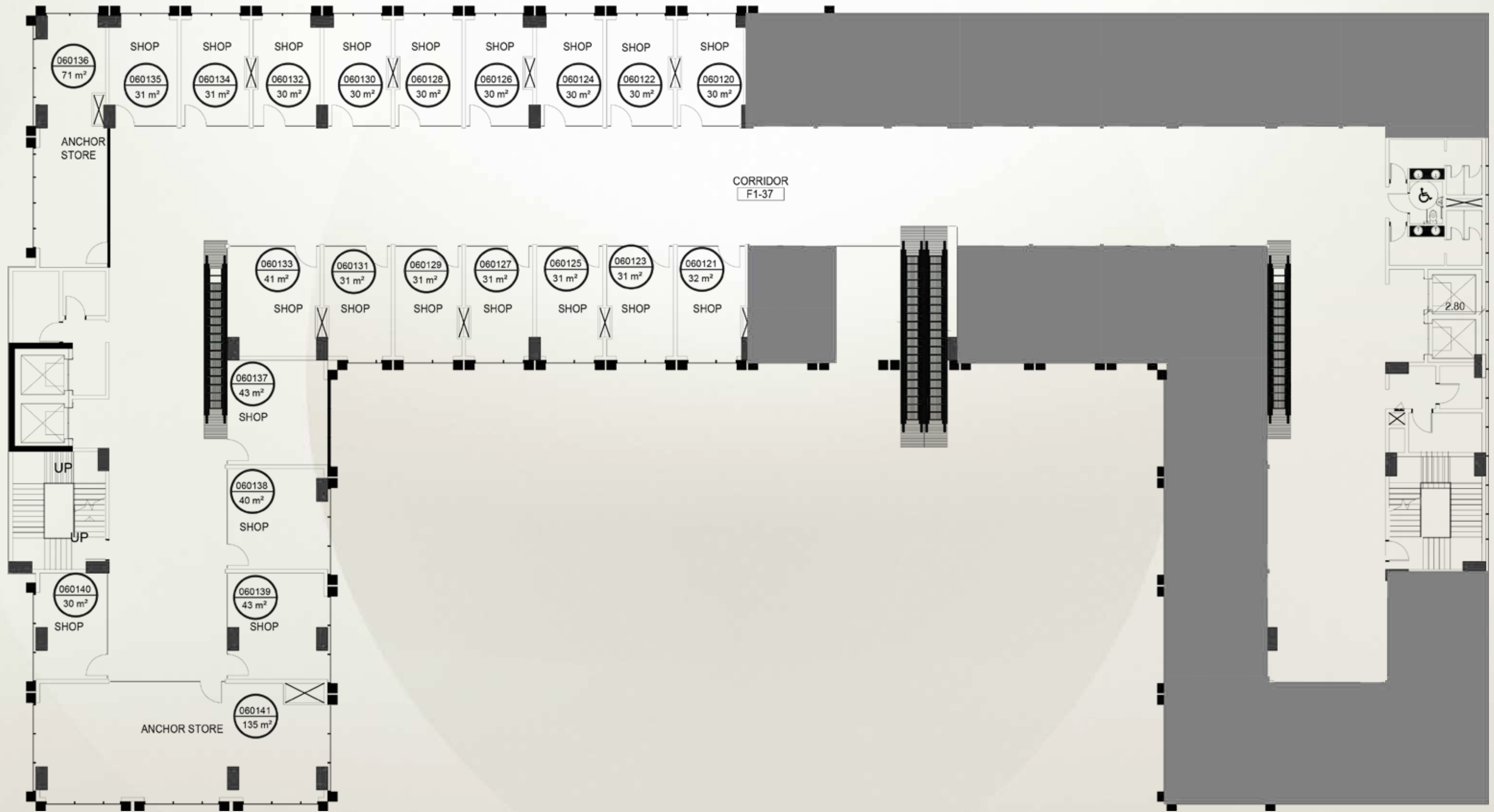



# SECOND FLOOR

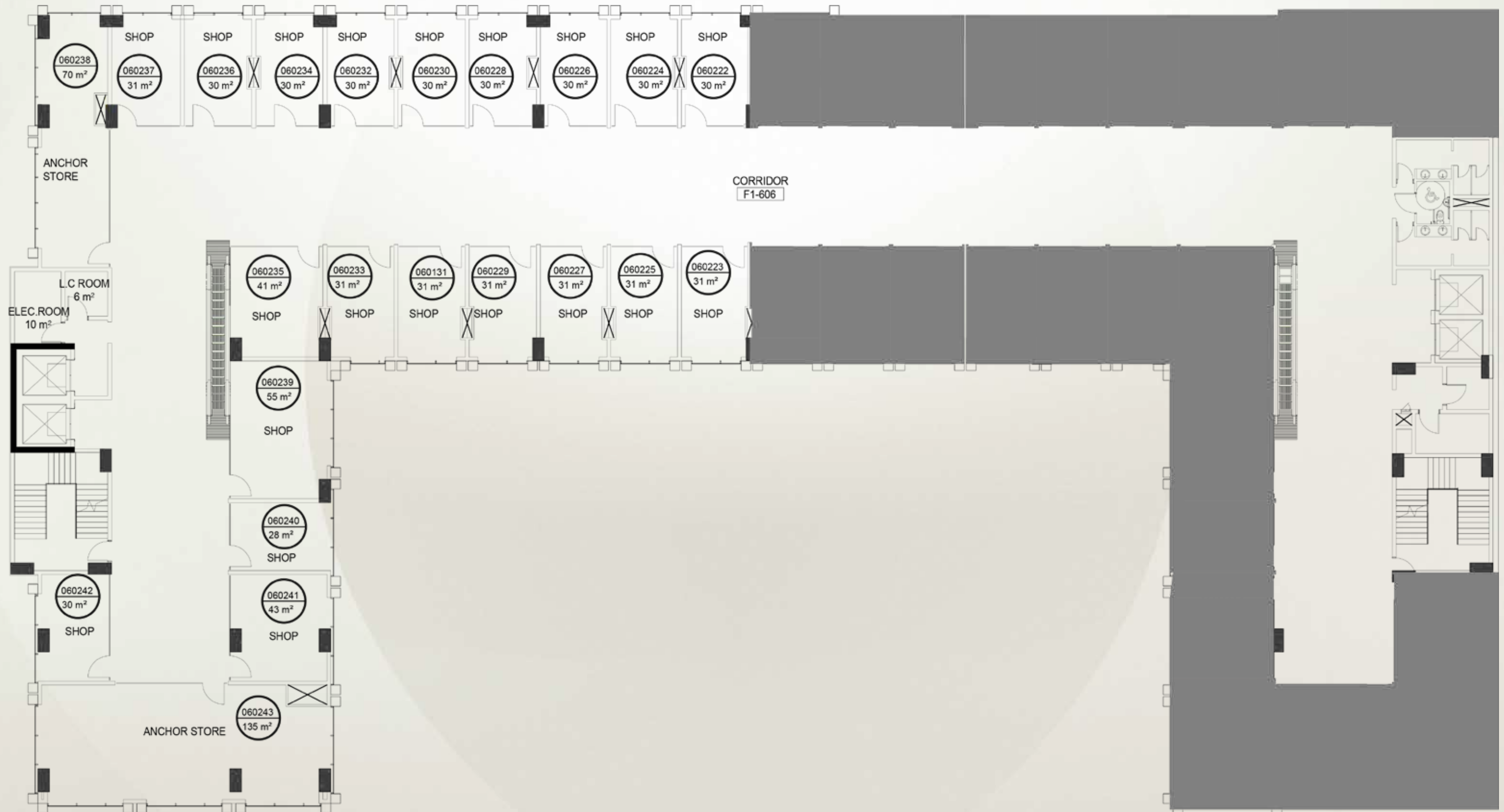



# THIRD FLOOR

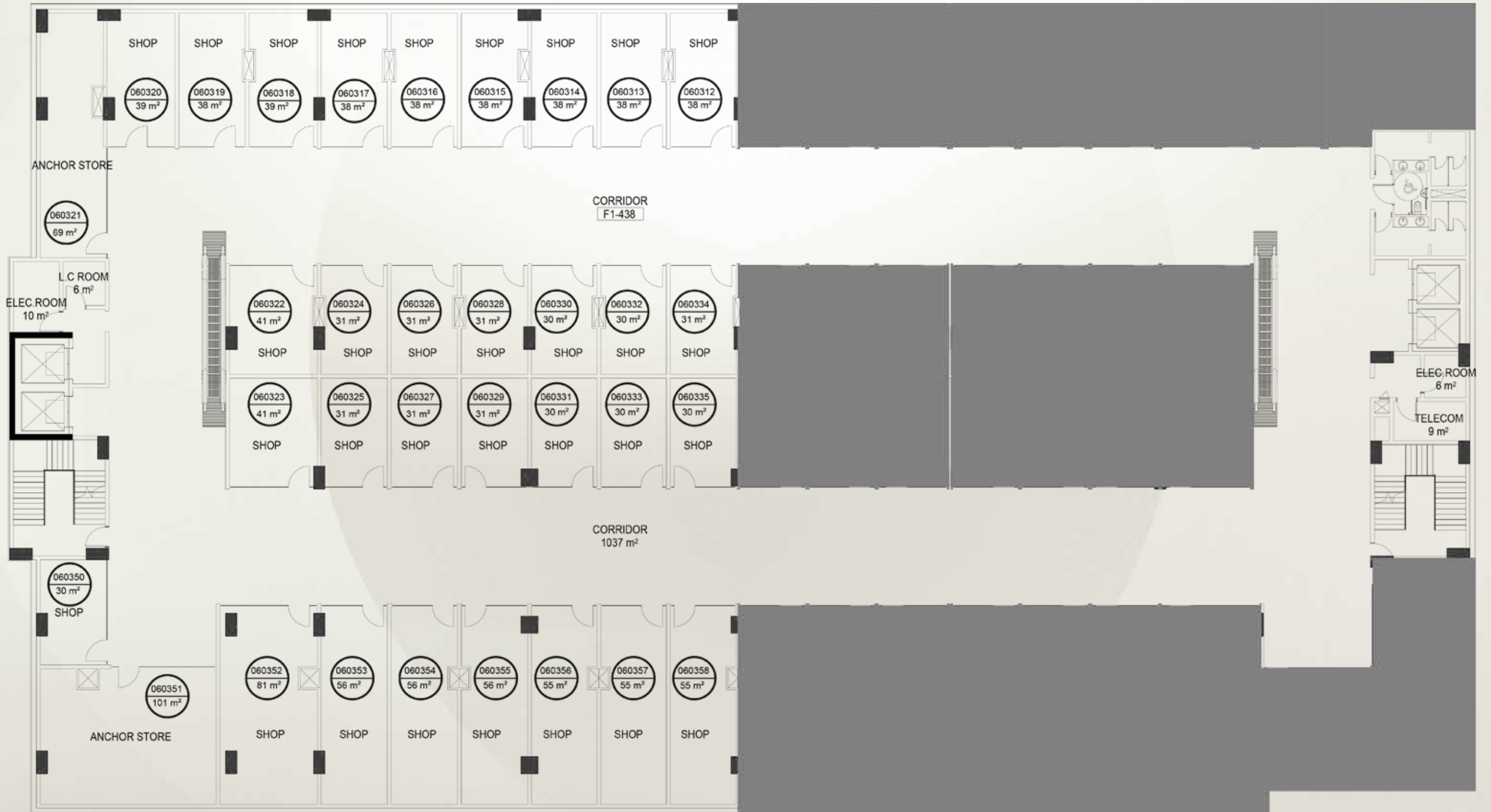



# FOURTH FLOOR (Food Court)

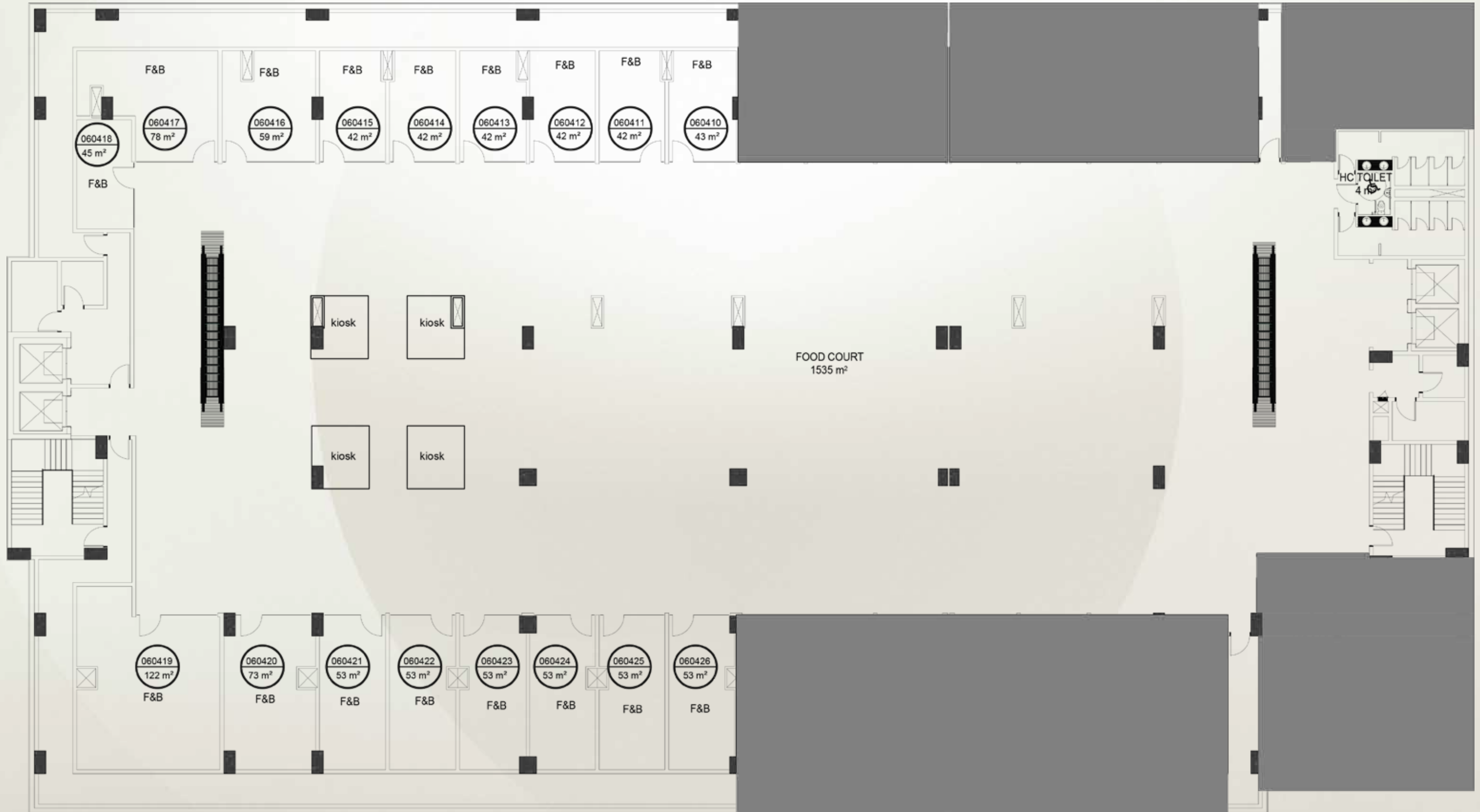



A circular graphic with a blurred background of a dollar sign and the word 'PAYMENT'. The dollar sign is in the upper half and 'PAYMENT' is in the lower half, both in a light yellow color. The background is a dark, textured surface with many fine, light-colored scratches or fibers. The entire graphic is set against a solid red background.

# **PAYMENT PLANS**



**%10** DOWN  
PAYMENT  
**6** YEARS

**%15** DOWN  
PAYMENT  
**7** YEARS

**03**

**%20** DOWN  
PAYMENT  
**8** YEARS

**%30** DOWN  
PAYMENT  
**9** YEARS

**%40** DOWN  
PAYMENT  
**12** YEARS

**06**

**%30** DOWN  
PAYMENT  
**%30** DISCOUNT  
**30** MONTH

**%30** DOWN  
PAYMENT  
**30** MONTHS  
1<sup>ST</sup> INSTALLMENT  
AFTER 30 MONTHS

**%20** DOWN  
PAYMENT  
**%10** DISCOUNT  
**6** YEARS

**09**

**%30** DOWN  
PAYMENT  
**%15** DISCOUNT  
**6** YEARS

**%40** DOWN  
PAYMENT  
**%20** DISCOUNT  
**6** YEARS

**%50** DOWN  
PAYMENT  
**%25** DISCOUNT  
**6** YEARS

**12**

**%100** CASH  
**%40** DISCOUNT



# OUR PARTNERS





The logo for DMA, consisting of the letters 'DMA' in a bold, dark blue, sans-serif font.

# DMA FOR DESIGN & ENGINEERING CONSULTANCY

## ARCHITECTURE DESIGN CONSULTANT

DMA is a multi-disciplinary consulting firm, specializing in Architecture, Urban Planning, Interior Design, Structure, MEP, Infrastructure & Construction Supervision; Carrying a cumulative experience of more than 30 years, with more than 250 Professionals, serving local & international markets covering a wide horizon of projects: Mixed use developments, Commercial, Residential, Educational, Hospitality, Healthcare & Administrative Projects. DMA has been awarded the ISO 2015 :9001 certification across all sectors, as well as winning many awards, one of which was the Quality Commitment Gold Crown Award, through the Quality Control Conference in London, 2015 making it the first Egyptian company to receive this award.







# SAMCO

## EXECUTION CONSULTANT

SAMCO was established driven by challenges to produce excellence, innovative, diversified developments and engineering solutions from concept to creation. SAMCO deals with many governmental departments such as Engineering Military Authority House, General Authority for Roads and Bridges, New Urban Community Authority, Great Cairo Development Authority, Sinai Development Authority, Port-Said Development Authority, Ministry of Housing and Urban Communities & the Ministry of Transportation in Egypt. SAMCO's objective is to transform and share experiences not only from roads and bridges but also to be self-resource independent global contractor in all majors.





