



EASTTOWER

DEVELOPED BY:



ABOUT UC

UC DEVELOPMENTS IS ONE OF THE LARGEST AND REMARKABLE ENTITIES IN EGYPT WITHIN THE CONSTRUCTION AND INVESTMENT FIELD. THE COMPANY WAS ESTABLISHED THROUGH THE ALLIANCE AND INTEGRATION OF A NUMBER OF REAL ESTATE EXPERTISE WORKING IN THE FIELD OF REAL ESTATE INVESTMENT, ENGINEERING, ARCHITECTURAL, MARKETING CONSULTANCY AND PROJECT MANAGEMENT IN THE EGYPTIAN MARKET SPANNING MORE THAN 20 YEARS. OUR PLAN IS TO INTRODUCE DIVERSE REAL ESTATE PROJECTS THAT MEET MARKET NEEDS AND PROVIDE INNOVATIVE AND SUSTAINABLE SOLUTIONS IN NEW CITIES.

FOR YEARS, UC DEVELOPMENTS HAS BEEN CRAFTING UNRIVALED EXPERIENCES FOR FAMILIES. THROUGH ITS COMMUNITY-CENTRIC DEVELOPMENTS, EVERY CORNER HAS BEEN REINVENTED INTO AN EXCLUSIVE HAVEN THAT STIMULATES A LINEAGE OF LIFESTYLES, IDEAS AND INDIVIDUAL INTERESTS. EVERY HOME AT UC DEVELOPMENTS IS TRULY WORTH A LIFETIME INVESTMENT. WITHIN UNMATCHED SURROUNDINGS, OUR HAND-PICKED COMMUNITIES GROW STRONGER TOGETHER, LOOKING AFTER ONE ANOTHER FROM ONE HERITAGE TO THE NEXT. OUR THRIVING COMMUNITIES ARE GUARANTEED UNPARALLELED EXPERIENCES, ADORNED WITH UNCONDITIONAL PRIVACY AND INTEGRATED LIVING.

OUR ASPIRATION TO PROVIDE DISTINCTIVE LIFESTYLES DRIVES OUR PASSION FOR DETAIL AND UNIQUE ARTISTRY. BY COLLABORATING WITH LEADING NAMES IN THE INDUSTRY, WE PLEDGE WORLD-CLASS AND PROFESSIONAL EXCELLENCE THAT AIM TO PROVIDE QUALITY-CONSCIOUS DEVELOPMENTS THROUGHOUT EVERY STAGE; FROM PLANNING, DESIGN AND CONSTRUCTION, TO EXECUTION, LANDSCAPING AND PROPERTY MANAGEMENT.

OUR VISION IS INNOVATING TO LEAD BY EXAMPLE IN BECOMING THE REGION'S LEADING DEVELOPER OF CHOICE, BY CRAFTING INTIMATE SETTINGS FOR COMMUNITIES TO FLOURISH, WHILE EXPERIENCING HOSPITALITY AND INTEGRATED LIVING AT ITS BEST.



ABOUT CENTRAL BUSINESS DISTRICT

THE CENTRAL BUSINESS DISTRICT IN THE NEW ADMINISTRATIVE CAPITAL IS CONSIDERED AS AN ARCHITECTURAL REVOLUTION AND A MAJOR CULTURAL TRANSFER TO EGYPT, AS IT AIMS TO ENTER EGYPT INTO THE ERA OF GLOBAL CITIES, WHICH ARE COMPETING WITH THE STRENGTH OF MAJOR GLOBAL CITIES, AND IT WILL HAVE A CENTRAL BUSINESS AREA DESIGNED AT THE HIGHEST LEVEL, AS IT REFLECTS THE URBAN AND REAL ESTATE DEVELOPMENT IN EGYPT AS WELL AS ECONOMIC DEVELOPMENT THAT AFFECTS THE ECONOMY, THE STATE AND ITS SIZE IN THE MIDDLE EAST AND THE ENTIRE WORLD.

IT IS LOCATED IN THE HEART OF THE NEW CAPITAL BETWEEN THE NORTHERN AND SOUTHERN AXES OF MOHAMMED BIN ZAYED, WHERE THE CITY IS LOCATED ABOUT 45 KILOMETERS FROM CAIRO, ABOUT 80 KILOMETERS FROM THE CITY OF SUEZ, AND ONLY 60 KILOMETERS FROM AL-AIN AL-SOKHNA AND MINUTES AWAY FROM AL-MOSTAKBAL CITY, MADINATY AND AL-REHAB.

THUS, THE FINANCIAL AND BUSINESS DISTRICT IS AN IMPORTANT ECONOMIC AND CULTURAL CENTER FOR THOSE LOOKING TO INVEST IN THE NEW ADMINISTRATIVE CAPITAL.

- IT INCLUDES 20 RESIDENTIAL, ADMINISTRATIVE, COMMERCIAL AND SERVICE TOWERS.
- IT INCLUDES THE CONSTRUCTION OF THE ICONIC TOWER, WHICH IS THE HIGHEST SKYSCRAPER IN AFRICA, WITH A HEIGHT OF ABOUT 345 METERS.
- THE FINANCIAL AND BUSINESS DISTRICT INCLUDES 12 COMMERCIAL COMPLEXES, 5 RESIDENTIAL BUILDINGS, TWO HOTELS, AS WELL AS SPORTS CLUBS, A CULTURAL CENTER AND A HOSPITAL.



ABOUT EASTTOWER

EAST TOWER IS DESIGNED WITH THE LATEST UPSCALE ARCHITECTURAL STYLE, AS THE EXECUTING COMPANY OF EAST TOWER PROJECT WAS KEEN TO PROVIDE THE BEST FOR ITS CUSTOMERS, SO THE BEST VITAL SITES WERE CHOSEN WITHIN THE NEW ADMINISTRATIVE CAPITAL, AND ALSO THE BEST ENGINEERING DESIGNS WERE CHOSEN TO BE THE FRONT OF THE PROJECT ALONG WITH THE EASY PAYMENT SYSTEMS AND PRICES.

ONE OF THE MOST IMPORTANT FEATURES OF THE EAST TOWER PROJECT IS THE DISTINGUISHED GEOGRAPHICAL LOCATION, WHERE THE CENTRAL BUSINESS DISTRICT AREA WAS CHOSEN WITHIN THE NEW ADMINISTRATIVE CAPITAL TO BE THE SITE OF THE EAST TOWER PROJECT IN THE NEW CAPITAL, AND ONE OF THE ADVANTAGES OF THIS SITE IS ITS PROXIMITY TO MANY REQUIRED FACILITIES AND VITAL FACILITIES AND EASE OF ACCESS AND TRANSPORTATION.

EAST TOWER WILL OFFER DIFFERENT AREAS AND DIFFERENT UNITS SO THAT THERE WILL BE DIFFERENT OPTIONS FOR EACH CUSTOMER. ADMINISTRATIVE, COMMERCIAL AND SERVICED HOTEL APARTMENT UNITS WERE PROVIDED. THE TOWER WILL BE 168 METERS AROUND +40 FLOORS OR MORE AND IT WILL BE ONE OF THE TALLEST BUILDINGS IN AFRICA. WITH A TOTAL INVESTMENT OF 7 BILLION EGYPTIAN POUNDS. ON A LAND AREA OF 12,000 SQUARE METERS. AND THE BUILT UP AREA IS 120,000 SQUARE METERS.





Madinaty

Mostakbal City

 EASTTOWER

National Ring Road

Presidential Palace

International Air Port

P1

R1

R2

R3

Opera

Financial District

Governmental District

Cabinet

Masa Hotel

Monorail Station

Downtown

P2

R4

R5

R6

Medical City

Expo City

Green River

R8

Arts & Culture

Middle Ring Road

R7

Diplomatic District

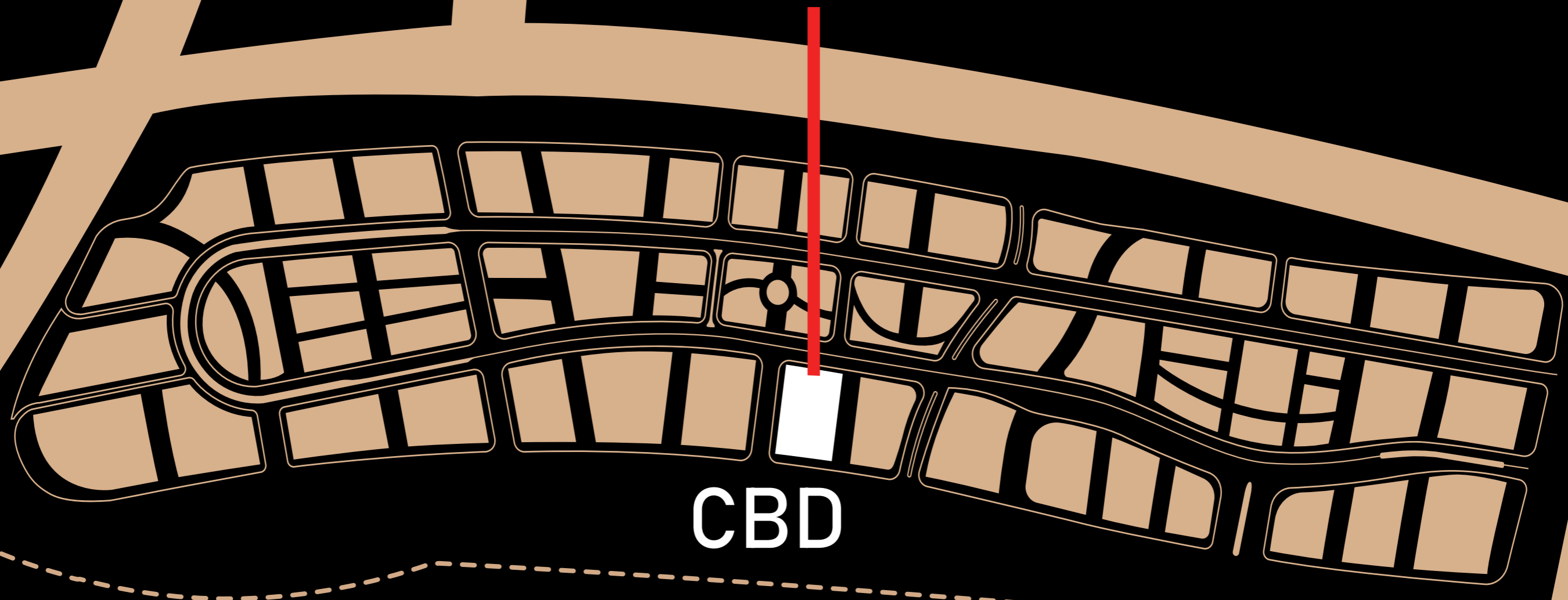

CBD

ACCESSIBILITY

- DIRECT VIEW ON THE ICONIC TOWER
- 125 METERS FROM THE GREEN RIVER
- 3 MINUTES FROM AL MASA HOTEL
- 2 MINUTES FROM THE REGIONAL RING ROAD
- 1 MINUTE OR 150 METERS FROM THE MONORAIL
- 2 MINS FROM THE MIDDLE RING ROAD

FACILITIES



INFINITY POOL



SKY RESTAURANT



SMART GATES

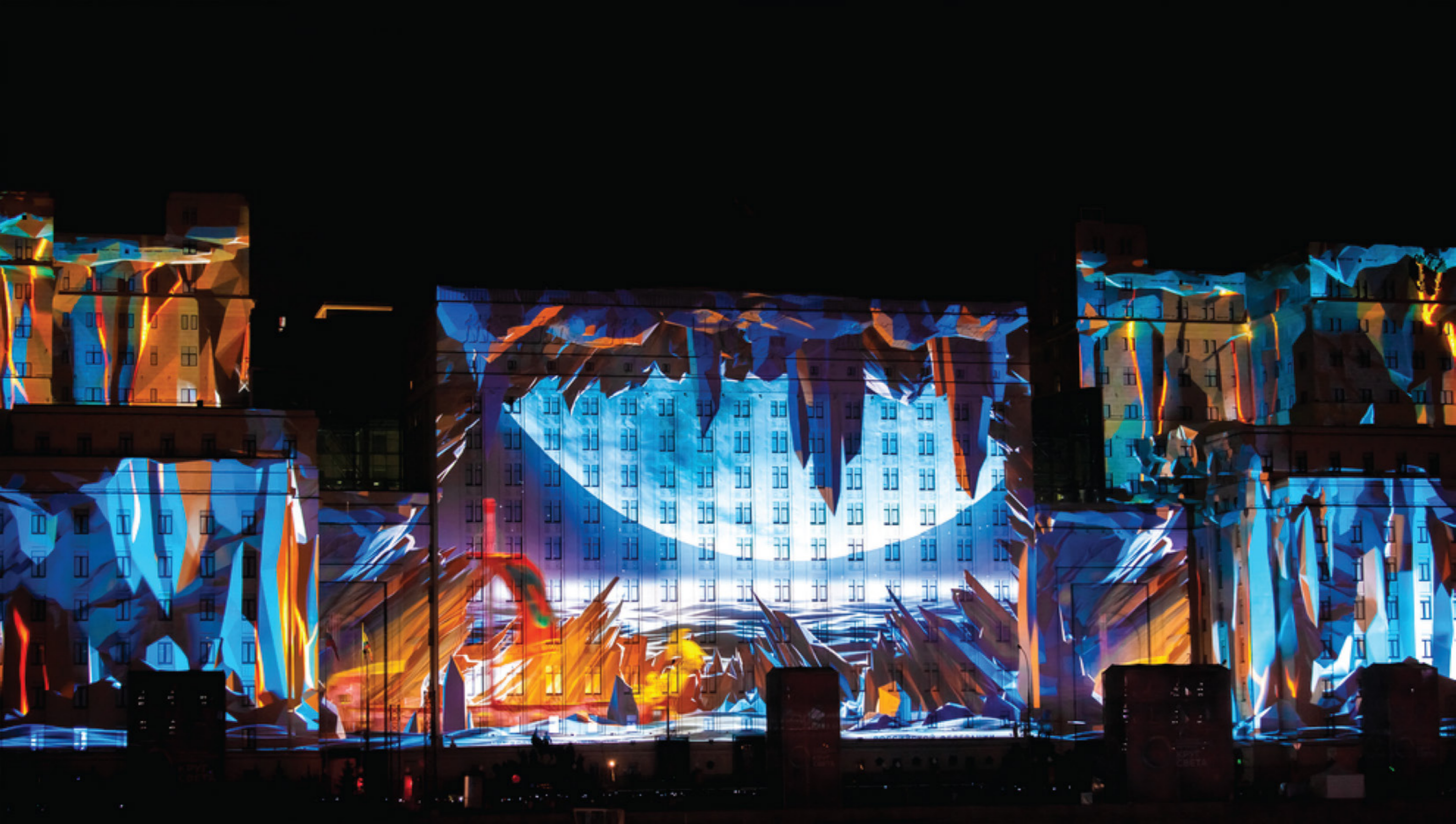

3D MAPPING



**DANCING
FOUNTAIN**



SKY LOUNGE



**FLOOR
AQUARIUM**



PARKING



**SECURITY
SYSTEM**



**FIRE FIGHTING
SYSTEM**



MEETING ROOMS

FLOOR PLAN



FLOOR	IN DOOR	OUTDOOR
G - 1	63	70
G - 2	77	176
G - 3	51	130
G - 4	51	107
G - 5	51	72
G - 6	51	50
G - 7	51	35
G - 8	40	16
G - 9	40	16
G - 10	40	16
G - 11	40	16
G - 12	40	16
G - 13	48	18
G - 14	60	31
G - 15	40	16
G - 16	51	24
G - 17	51	27
G - 18	51	36
G - 19	51	50
G - 20	67	162
G - 21	51	97
G - 22	51	65
G - 23	51	43
G - 24	51	30
G - 25	79	55
G - 26	51	44
G - 27	51	65
G - 28	51	98
G - 29	51	109
G - 30	51	75
G - 31	86	
G - 32	51	
G - 33	40	
G - 34	40	16
G - 35	40	16
G - 36	40	30
G - 37	40	16
G - 38	51	25
G - 39	51	30
G - 40	51	37
G - 41	51	51
G - 42	51	74
G - 43	51	102
G - 44	51	106

G - 45	67	153
G - 46	51	61
G - 47	51	49
G - 48	69	18
G - 49	45	12
G - 50	45	12
G - 51	45	12
G - 52	45	12
G - 53	31	11
G - 54	31	11
G - 55	31	11
G - 56	31	11
G - 57	31	11
G - 58	31	11
G - 59	31	11
G - 60	31	11
G - 61	31	11
G - 62	45	12
G - 63	45	12
G - 64	45	12
G - 65	45	12
G - 66	45	12
G - 67	45	12
G - 68	45	12
G - 69	45	12
G - 70	45	12
G - 71	45	12
G - 72	45	12
G - 73	45	12
G - 74	31	11
G - 75	31	11
G - 76	31	11
G - 77	31	11
G - 78	31	11
G - 79	31	11
G - 80	31	11
G - 81	31	11
G - 82	31	11
G - 83	45	12
G - 84	45	12
G - 85	45	12
G - 86	45	12
G - 87	69	18

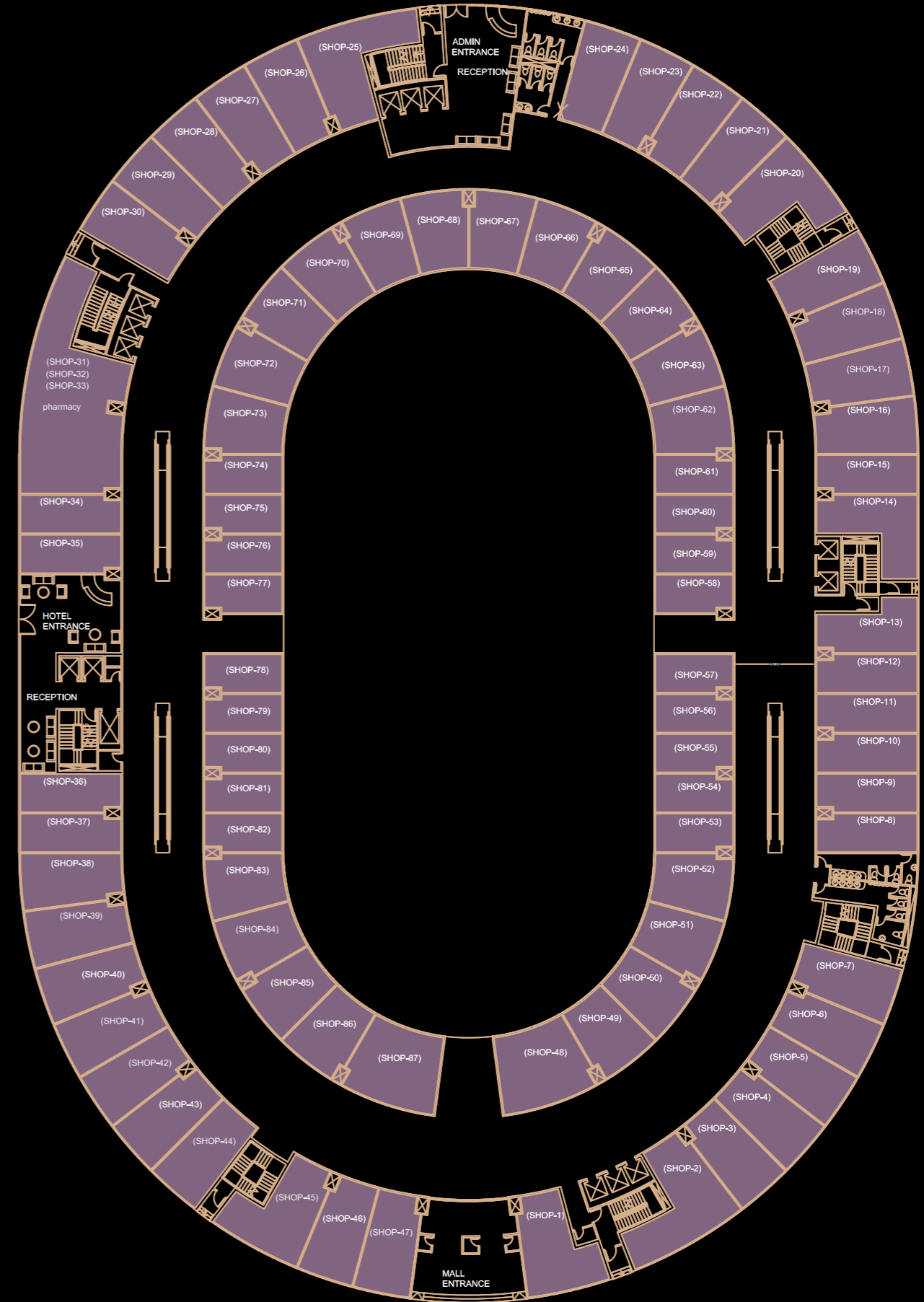

GROUND FLOOR PLAN
COMMERCIAL FLOOR

FLOOR	IN DOOR
F01- 01	77
F01- 02	51
F01- 03	51
F01- 04	51
F01- 05	51
F01- 06	61
F01- 07	40
F01- 08	40
F01- 09	40
F01- 10	40
F01- 11	40
F01- 12	54
F01- 13	58
F01- 14	40
F01- 15	51
F01- 16	51
F01- 17	51
F01- 18	60
F01- 19	67
F01- 20	51
F01- 21	51
F01- 22	51
F01- 23	51
F01- 24	63
F01- 25	82
F01- 26	51
F01- 27	51
F01- 28	51
F01- 29	51
F01- 30	63
F01- 31	83
F01- 32	51
F01- 33	40
F01- 34	40
F01- 35	40
F01- 36	40
F01- 37	63
F01- 38	66
F01- 39	40
F01- 40	51
F01- 41	51
F01- 42	51
F01- 43	51
F01- 44	51
F01- 45	51
F01- 46	64
F01- 47	64
F01- 48	51

F01- 49	51
F01- 50	51
F01- 51	51
F01- 52	73
F01- 53	45
F01- 54	45
F01- 55	45
F01- 56	45
F01- 57	45
F01- 58	31
F01- 59	31
F01- 60	31
F01- 61	31
F01- 62	31
F01- 63	31
F01- 64	31
F01- 65	31
F01- 66	31
F01- 67	31
F01- 68	45
F01- 69	45
F01- 70	45
F01- 71	45
F01- 72	45
F01- 73	45
F01- 74	45
F01- 75	45
F01- 76	45
F01- 77	45
F01- 78	45
F01- 79	45
F01- 80	31
F01- 81	31
F01- 82	31
F01- 83	31
F01- 84	31
F01- 85	31
F01- 86	31
F01- 87	31
F01- 88	31
F01- 89	31
F01- 90	45
F01- 91	45
F01- 92	45
F01- 93	45
F01- 94	45
F01- 95	45
F01- 96	45

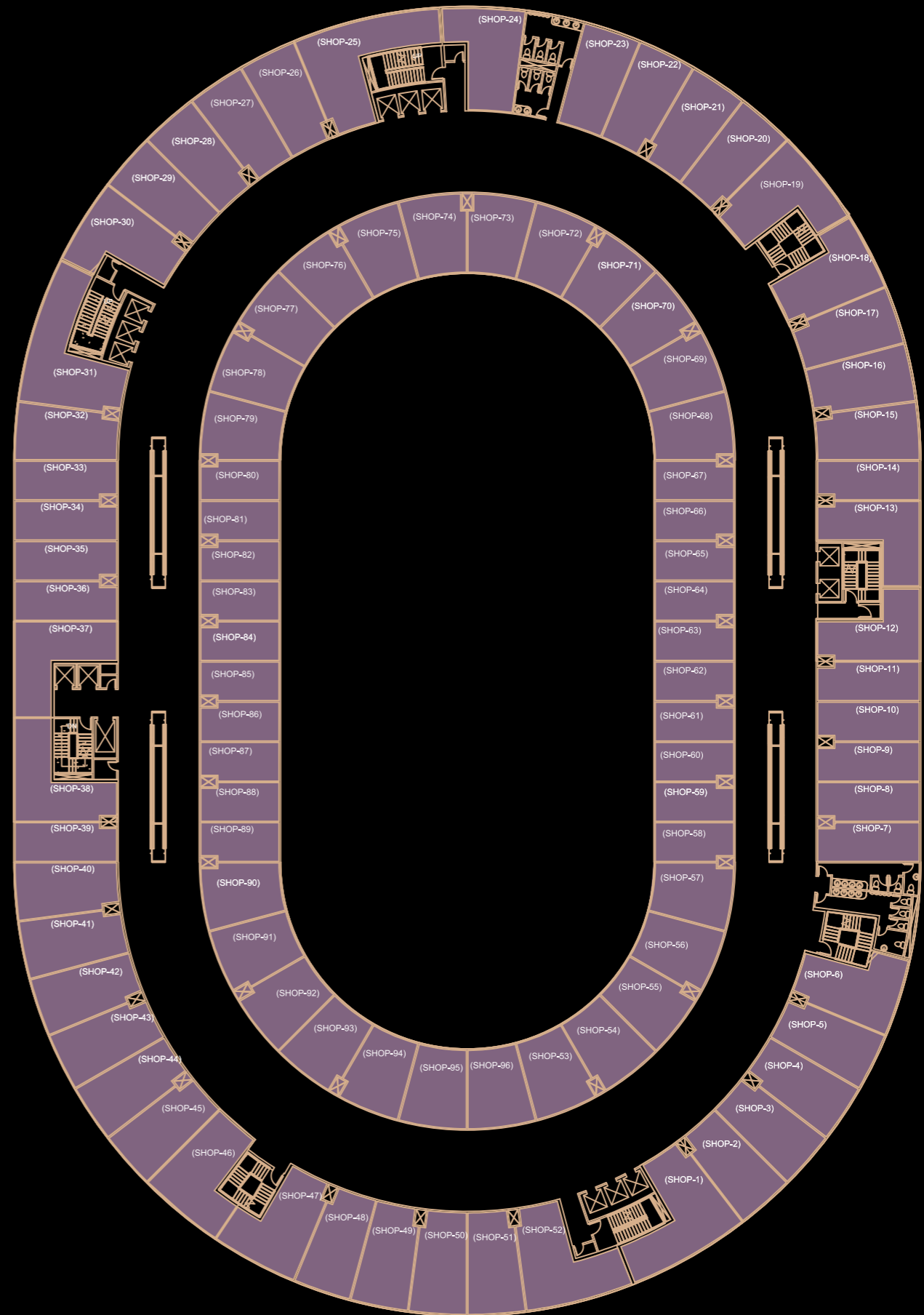

FIRST FLOOR PLAN
COMMERCIAL FLOOR

FLOOR	IN DOOR	OUTDOOR
F02-01	51	48
F02-02	48	32
F02-03	48	32
F02-04	48	32
F02-05	48	32
F02-06	51	46
F02-07	51	47
F02-08	41	33
F02-09	41	33
F02-10	41	33
F02-11	41	33
F02-12	41	33
F02-13	44	43
F02-14	44	43
F02-15	41	33
F02-16	48	31
F02-17	48	31
F02-18	48	31
F02-19	51	43
F02-20	51	46
F02-21	48	31
F02-22	48	31
F02-23	48	31
F02-24	48	31
F02-25	48	32
F02-26	51	50

F02-27	48	31
F02-28	51	31
F02-29	51	31
F02-30	51	31
F02-31	51	60
F02-32	51	59
F02-33	48	31
F02-34	41	33
F02-35	41	33
F02-36	41	33
F02-37	41	33
F02-38	44	45
F02-39	44	51
F02-40	41	33
F02-41	48	32
F02-42	48	32
F02-43	48	32
F02-44	48	32
F02-45	48	32
F02-46	48	32
F02-47	51	48
F02-48	51	46
F02-49	48	32
F02-50	48	32
F02-51	48	32
F02-52	48	32
F02-53	51	32

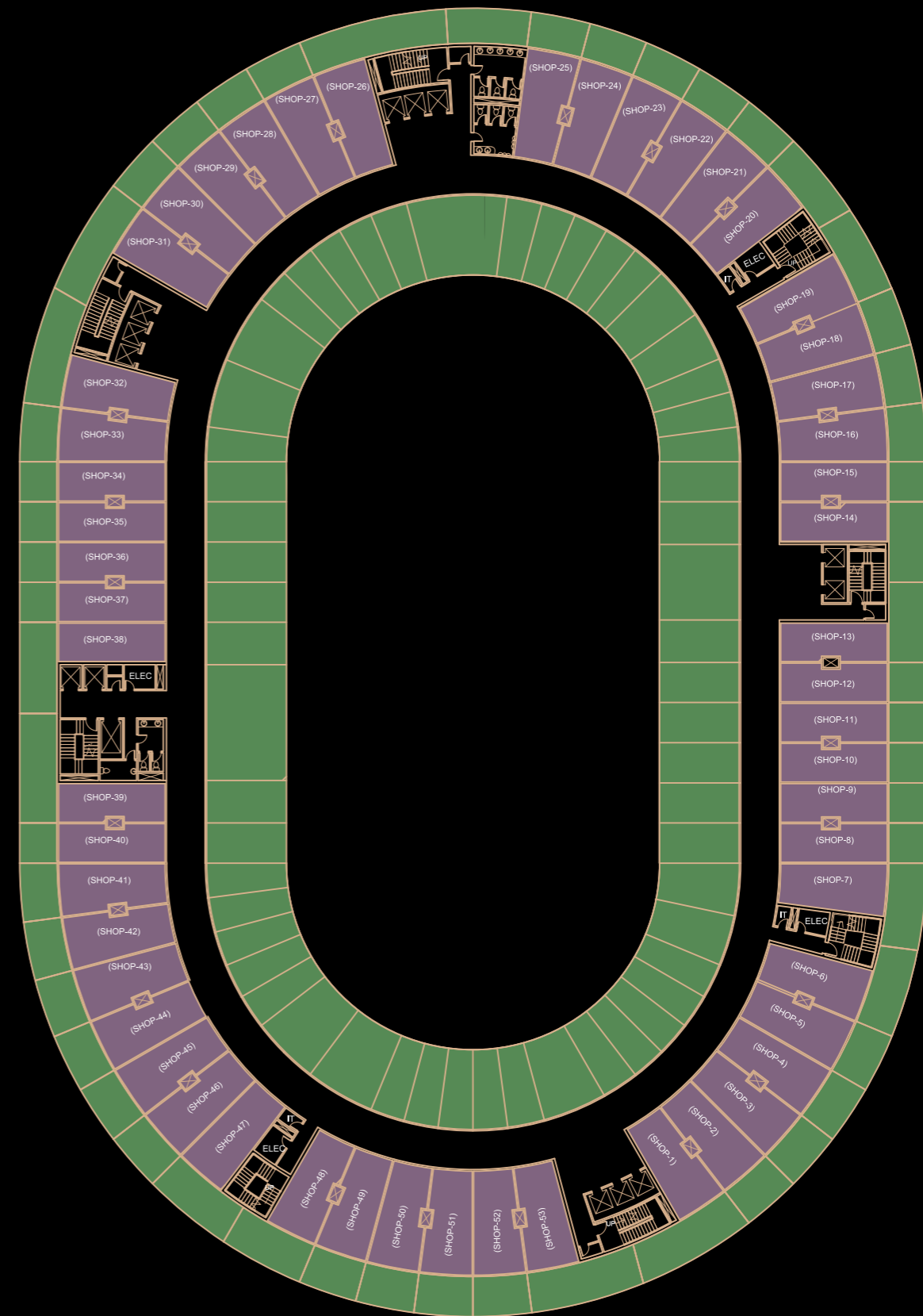

SECOND FLOOR PLAN
COMMERCIAL FLOOR

FLOOR	IN DOOR
F03-01	44
F03-02	44
F03-03	44
F03-04	44
F03-05	44
F03-06	44
F03-07	44
F03-08	51
F03-09	51
F03-10	51
F03-11	51
F03-12	51
F03-13	51
F03-14	51
F03-15	51
F03-16	51
F03-17	51
F03-18	51
F03-19	51
F03-20	51
F03-21	51
F03-22	51
F03-23	51
F03-24	51
F03-25	51
F03-26	44

F03-27	44
F03-28	44
F03-29	44
F03-30	44
F03-31	44
F03-32	44
F03-33	44
F03-34	51
F03-35	51
F03-36	51
F03-37	51
F03-38	51
F03-39	51
F03-40	51
F03-41	51
F03-42	51
F03-43	51
F03-44	51
F03-45	51
F03-46	51
F03-47	51
F03-48	51
F03-49	51
F03-50	51
F03-51	51
F03-52	51
F03-53	51

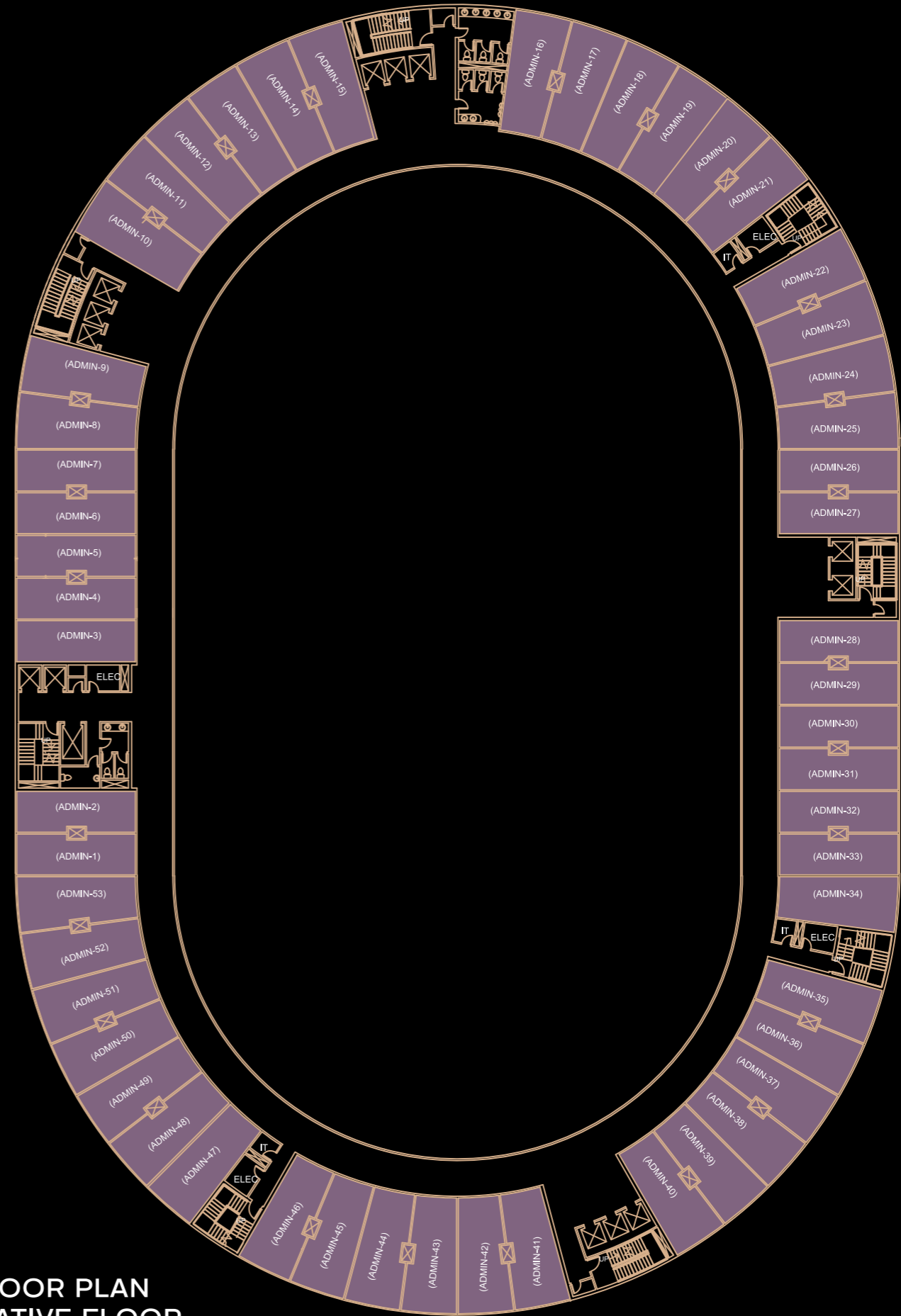

THIRD FLOOR PLAN
ADMINISTRATIVE FLOOR

FLOOR	IN DOOR
F04-01	44
F04-02	44
F04-03	44
F04-04	44
F04-05	44
F04-06	44
F04-07	44
F04-08	51
F04-09	51
F04-10	51
F04-11	51
F04-12	51
F04-13	51
F04-14	51
F04-15	51
F04-16	51
F04-17	51
F04-18	51
F04-19	51
F04-20	51
F04-21	51
F04-22	51
F04-23	51
F04-24	51
F04-25	51
F04-26	44

F04-27	44
F04-28	44
F04-29	44
F04-30	44
F04-31	44
F04-32	44
F04-33	44
F04-34	51
F04-35	51
F04-36	51
F04-37	51
F04-38	51
F04-39	51
F04-40	51
F04-41	51
F04-42	51
F04-43	51
F04-44	51
F04-45	51
F04-46	51
F04-47	51
F04-48	51
F04-49	51
F04-50	51
F04-51	51
F04-52	51
F04-53	51

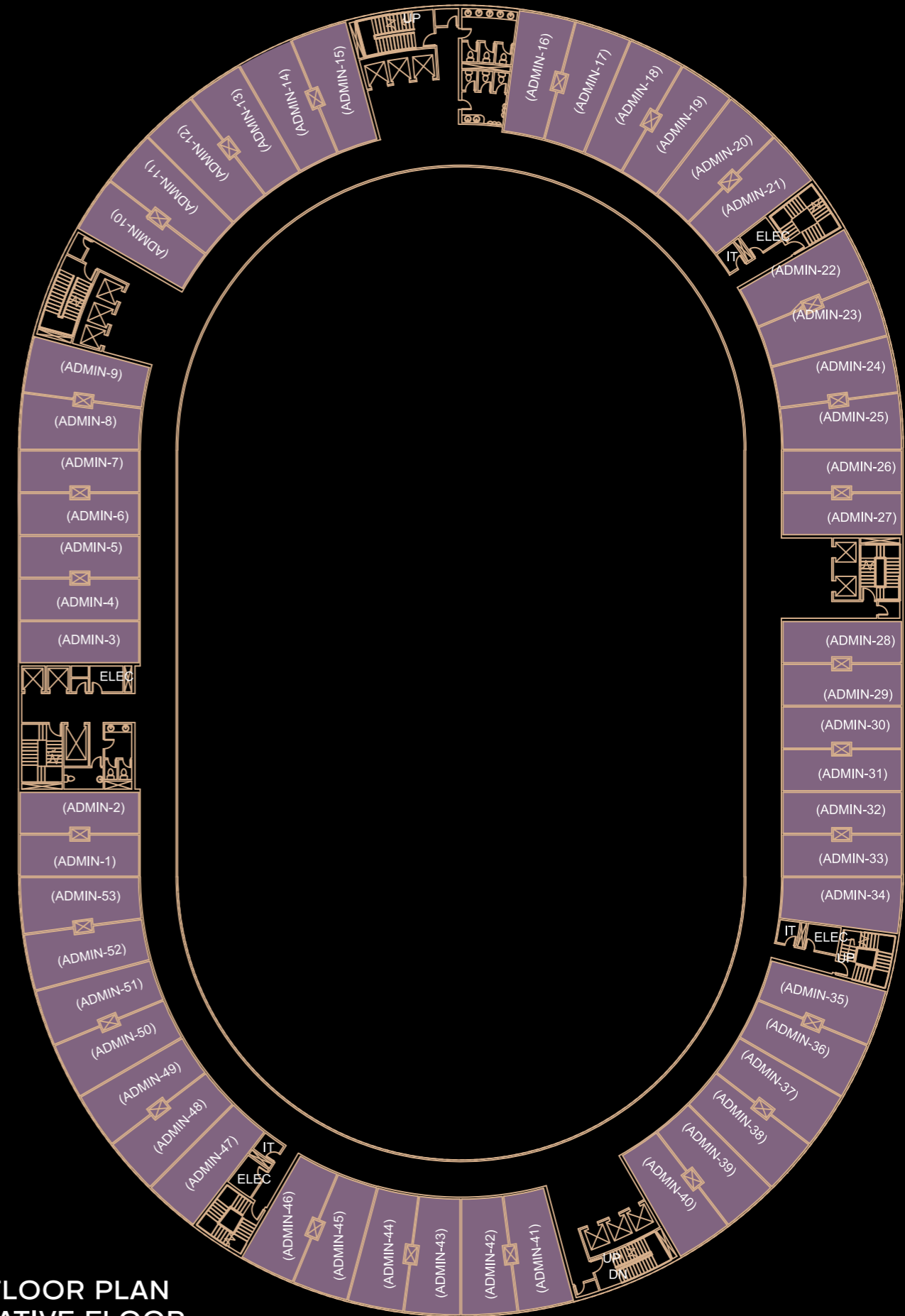

FOURTH FLOOR PLAN
ADMINISTRATIVE FLOOR

FLOOR	IN DOOR
F05-01	44
F05-02	44
F05-03	44
F05-04	44
F05-05	44
F05-06	44
F05-07	44
F05-08	51
F05-09	51
F05-10	51
F05-11	51
F05-12	51
F05-13	51
F05-14	51
F05-15	51
F05-16	51
F05-17	51
F05-18	51
F05-19	51
F05-20	51
F05-21	51
F05-22	51
F05-23	51
F05-24	51
F05-25	51
F05-26	44

F05-27	44
F05-28	44
F05-29	44
F05-30	44
F05-31	44
F05-32	44
F05-33	44
F05-34	51
F05-35	51
F05-36	51
F05-37	51
F05-38	51
F05-39	51
F05-40	51
F05-41	51
F05-42	51
F05-43	51
F05-44	51
F05-45	51
F05-46	51
F05-47	51
F05-48	51
F05-49	51
F05-50	51
F05-51	51
F05-52	51
F05-53	51

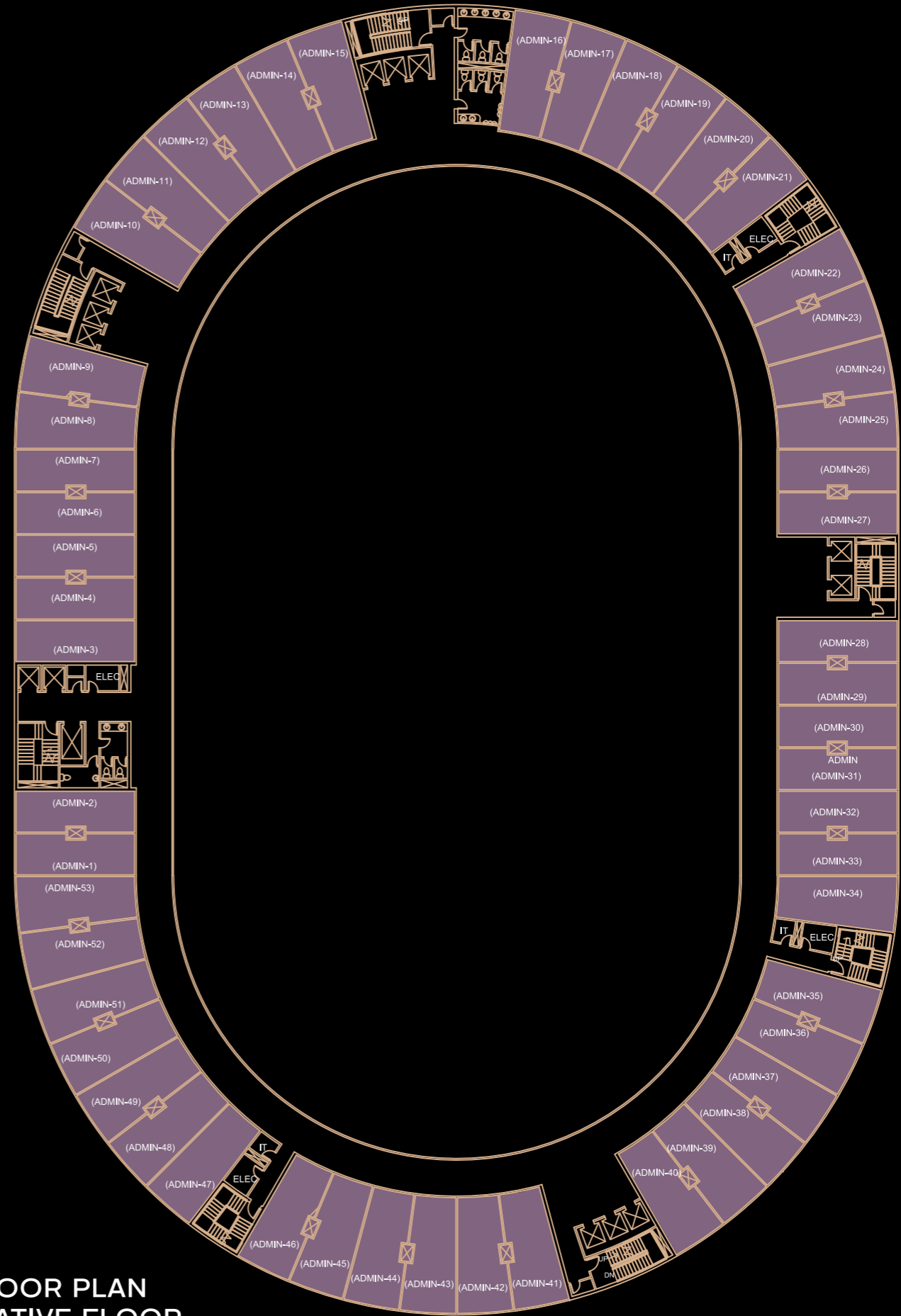

**FIFTH FLOOR PLAN
ADMINISTRATIVE FLOOR**

FLOOR	IN DOOR
F06-01	58
F06-02	58
F06-03	44
F06-04	44
F06-05	44
F06-06	44
F06-07	44
F06-08	51
F06-09	51
F06-10	51
F06-11	51
F06-12	51
F06-13	51
F06-14	51
F06-15	51
F06-16	51
F06-17	51
F06-18	51
F06-19	51
F06-20	51
F06-21	51
F06-22	51
F06-23	51
F06-24	51
F06-25	51
F06-26	44

F06-27	44
F06-28	44
F06-29	44
F06-30	44
F06-31	44
F06-32	44
F06-33	44
F06-34	51
F06-35	51
F06-36	51
F06-37	51
F06-38	51
F06-39	51
F06-40	51
F06-41	51
F06-42	51
F06-43	51
F06-44	51
F06-45	51
F06-46	51
F06-47	51
F06-48	51
F06-49	58
F06-50	127

80

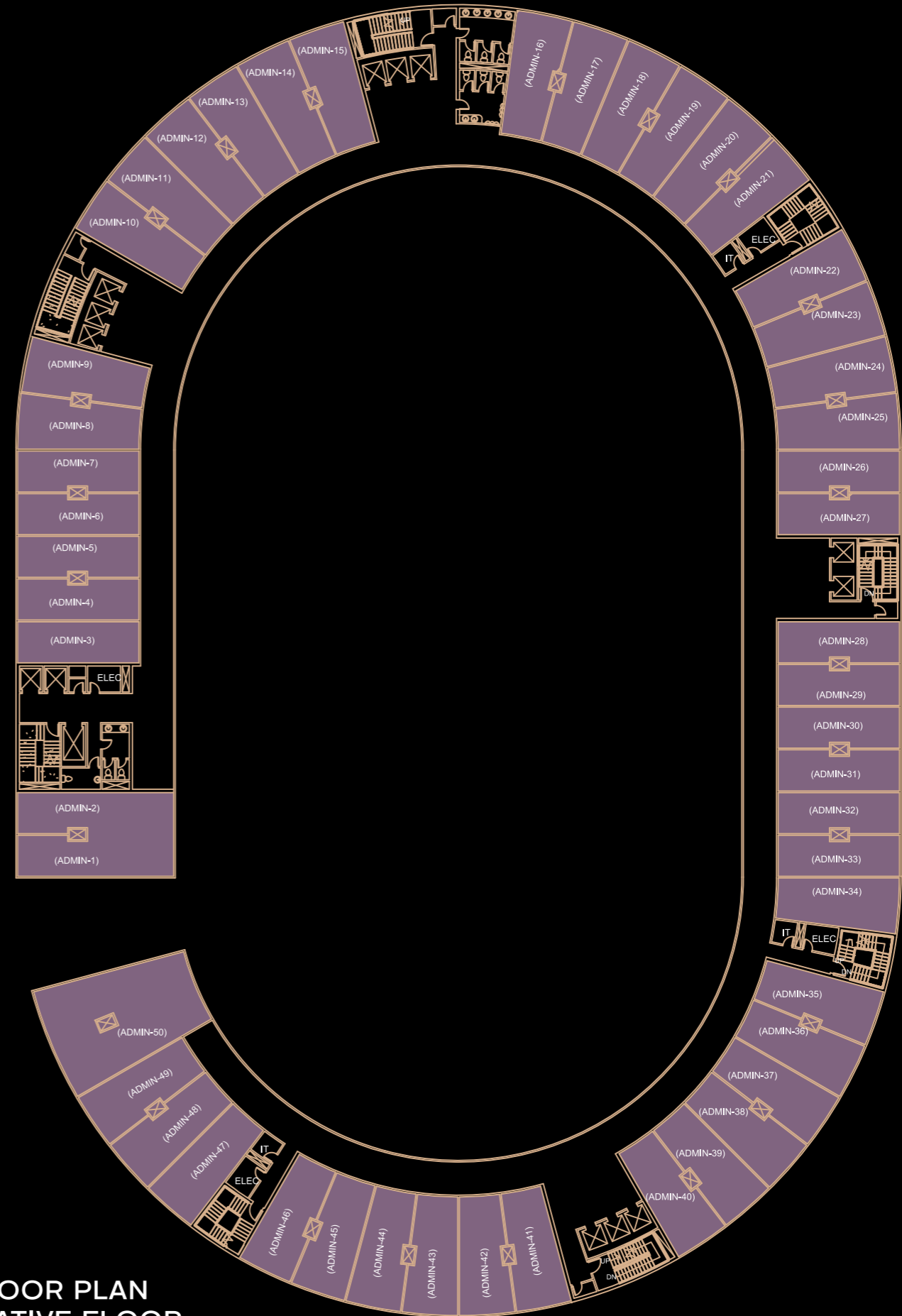

SIXTH FLOOR PLAN
ADMINISTRATIVE FLOOR

FLOOR	INDOOR
F07-1	58
F07-2	58
F07-3	44
F07-4	44
F07-5	44
F07-6	44
F07-7	44
F07-8	51
F07-9	51
F07-10	51
F07-11	51
F07-12	51
F07-13	51
F07-14	51
F07-15	51
F07-16	51
F07-17	51
F07-18	51
F07-19	51
F07-20	51
F07-21	51
F07-22	51
F07-23	51
F07-24	51

F07-25	51
F07-26	44
F07-27	44
F07-28	44
F07-29	44
F07-30	44
F07-31	44
F07-32	44
F07-33	44
F07-34	51
F07-35	51
F07-36	51
F07-37	51
F07-38	51
F07-39	51
F07-40	51
F07-41	51
F07-42	51
F07-43	51
F07-44	51
F07-45	51
F07-46	51
F07-47	51
F07-48	58
F07-49	64
80	

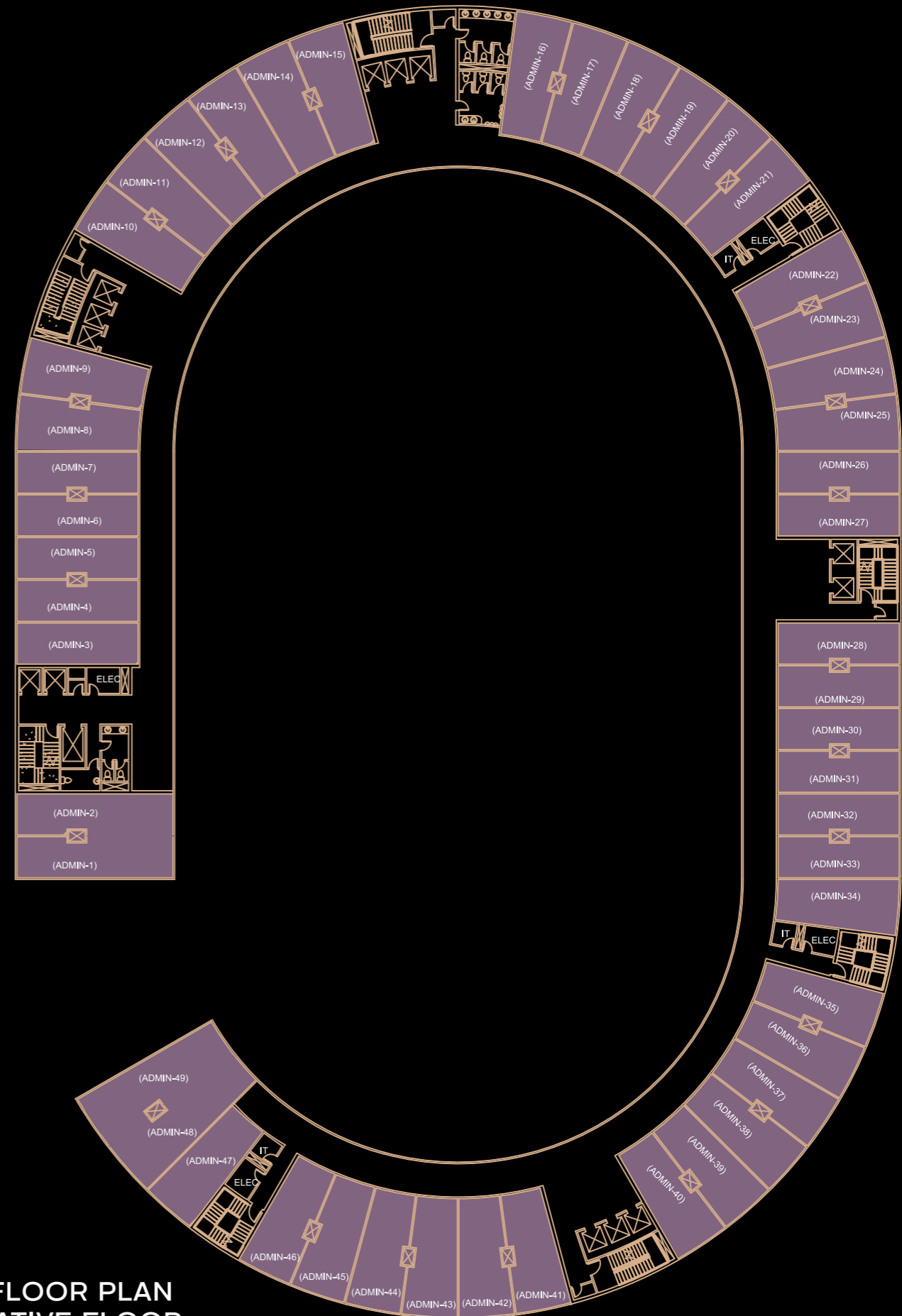

**SEVENTH FLOOR PLAN
ADMINISTRATIVE FLOOR**

FLOOR	INDOOR
F08-1	58
F08-2	58
F08-3	44
F08-4	44
F08-5	44
F08-6	44
F08-7	44
F08-8	51
F08-9	51
F08-10	51
F08-11	51
F08-12	51
F08-13	51
F08-14	51
F08-15	51
F08-16	51
F08-17	51
F08-18	51
F08-19	51
F08-20	51
F08-21	51
F08-22	51
F08-23	51
F08-24	51

F08-25	51
F08-26	44
F08-27	44
F08-28	44
F08-29	44
F08-30	44
F08-31	44
F08-32	44
F08-33	44
F08-34	51
F08-35	51
F08-36	51
F08-37	51
F08-38	51
F08-39	51
F08-40	51
F08-41	51
F08-42	51
F08-43	51
F08-44	51
F08-45	51
F08-46	51
F08-47	64

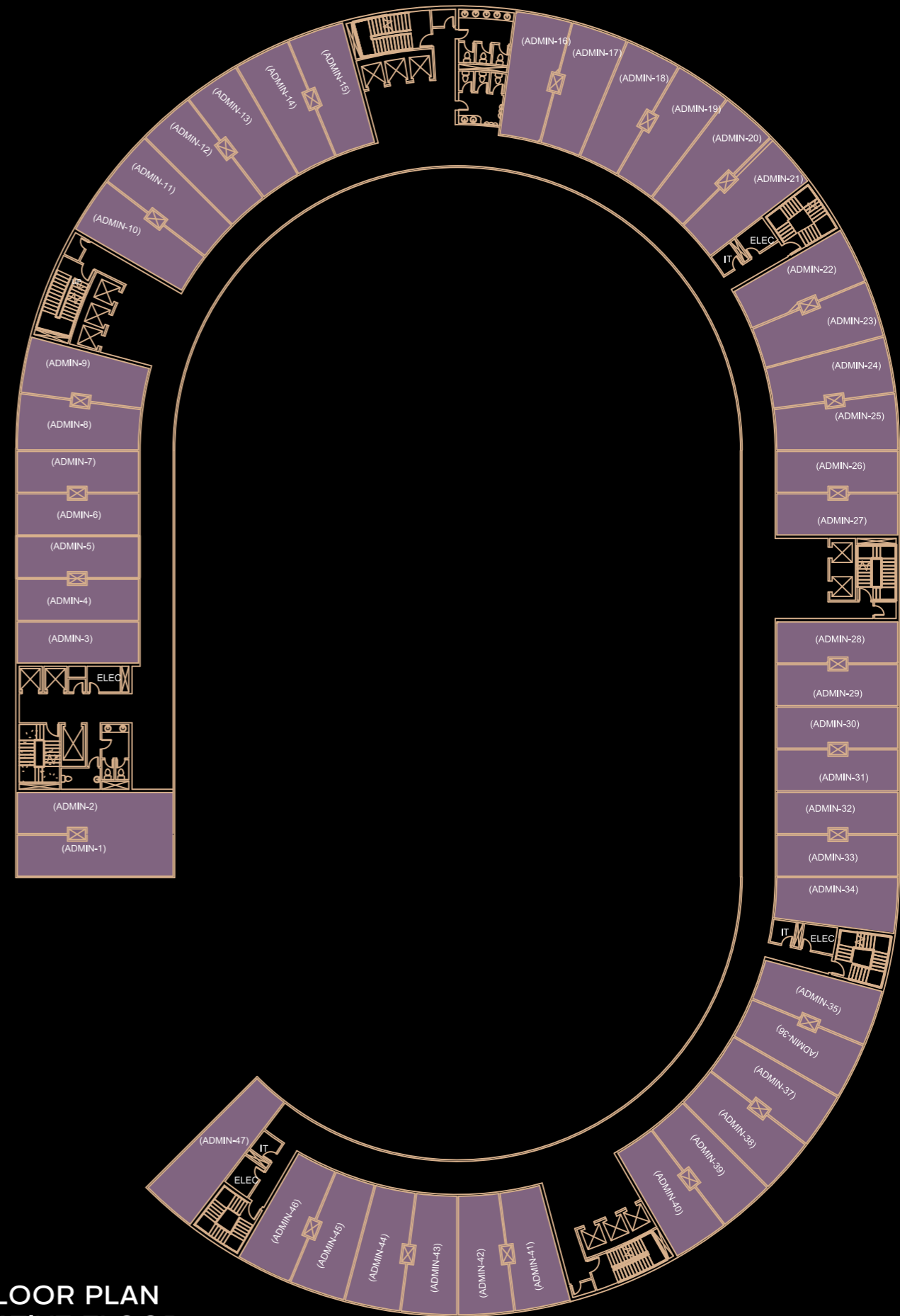

**EIGHTH FLOOR PLAN
ADMINISTRATIVE FLOOR**

FLOOR	INDOOR
F09-1	53
F09-2	40
F09-3	32
F09-4	32
F09-5	32
F09-6	32
F09-7	32
F09-8	32
F09-9	31
F09-10	31
F09-11	31
F09-12	31
F09-13	31
F09-14	31
F09-15	31
F09-16	31
F09-17	31
F09-18	31
F09-19	31
F09-20	31
F09-21	31
F09-22	31
F09-23	31
F09-24	31
F09-25	32
F09-26	32
F09-27	32
F09-28	32
F09-29	32
F09-30	32
F09-31	53
F09-32	31
F09-33	31
F09-34	31
F09-35	31
F09-36	31
F09-37	31

F09-38	31
F09-39	31
F09-40	31
F09-41	64
F09-42	38
F09-43	31
F09-44	31
F09-45	31
F09-46	32
F09-47	31
F09-48	31
F09-49	31
F09-50	31
F09-51	31
F09-52	32
F09-53	58
F09-54	53
F09-55	77
F09-56	83
F09-57	32
F09-58	32
F09-59	32
F09-60	32
F09-61	32
F09-62	32
F09-63	32
F09-64	32
F09-65	32
F09-66	32
F09-67	32
F09-68	32
F09-69	32
F09-70	32
F09-71	32
F09-72	32
F09-73	57
F09-74	51
F09-75	58

80

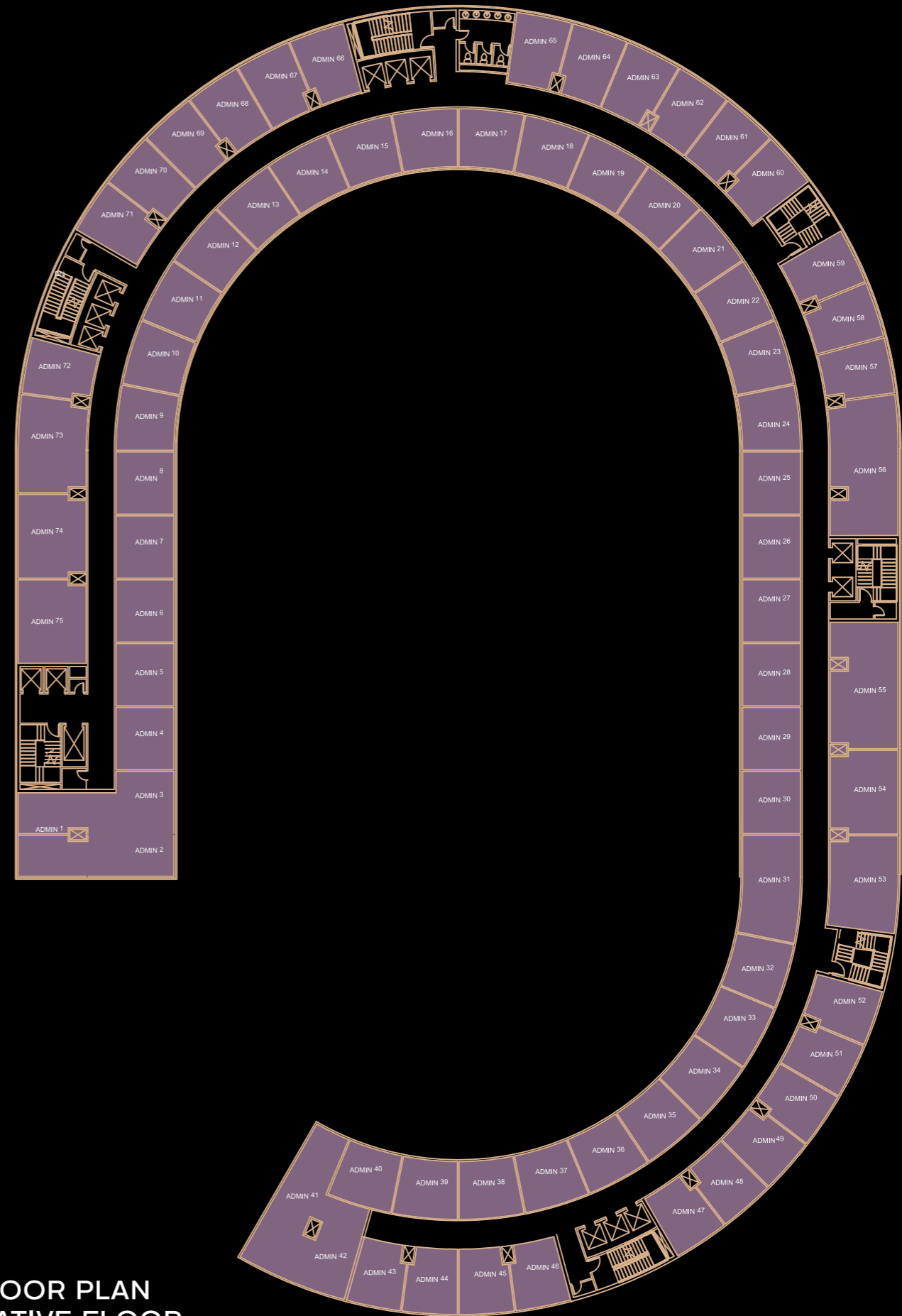

**NINTH FLOOR PLAN
ADMINISTRATIVE FLOOR**

FLOOR	INDOOR
F10-1	58
F10-2	58
F10-3	44
F10-4	44
F10-5	44
F10-6	44
F10-7	44
F10-8	53
F10-9	53
F10-10	53
F10-11	53
F10-12	53
F10-13	53
F10-14	53
F10-15	53
F10-16	53
F10-17	53
F10-18	53
F10-19	53
F10-20	53
F10-21	53
F10-22	53

F10-23	53
F10-24	53
F10-25	53
F10-26	45
F10-27	45
F10-28	45
F10-29	45
F10-30	45
F10-31	45
F10-32	45
F10-33	45
F10-34	53
F10-35	53
F10-36	53
F10-37	53
F10-38	53
F10-39	53
F10-40	53
F10-41	53
F10-42	53
F10-43	64
F10-44	64
80	

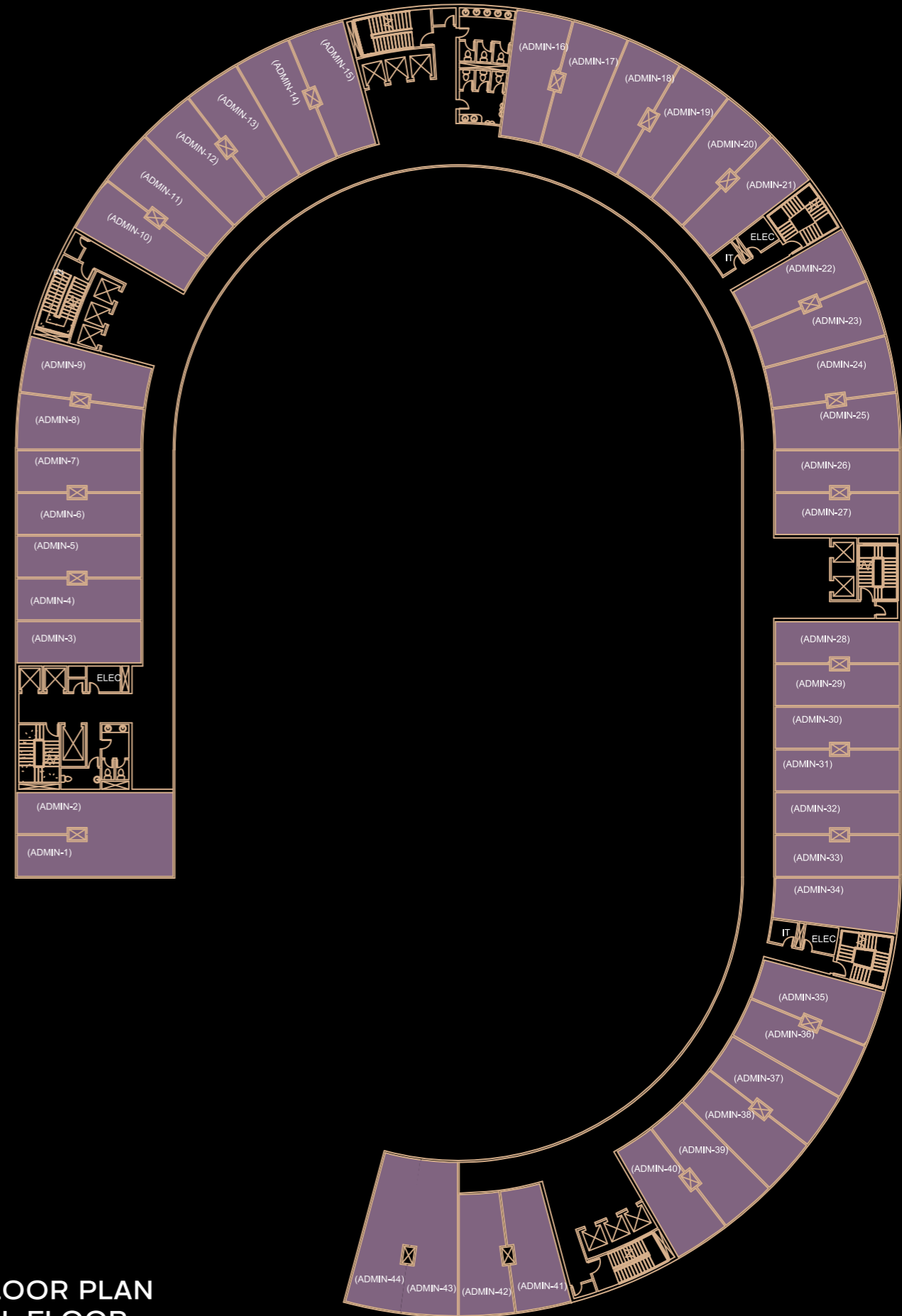

TENTH FLOOR PLAN
MEDICAL FLOOR

FLOOR	INDOOR
F11-1	58
F11-2	58
F11-3	44
F11-4	44
F11-5	44
F11-6	44
F11-7	44
F11-8	53
F11-9	53
F11-10	53
F11-11	53
F11-12	53
F11-13	53
F11-14	53
F11-15	53
F11-16	53
F11-17	53
F11-18	53
F11-19	53
F11-20	53
F11-21	53

F11-22	53
F11-23	53
F11-24	53
F11-25	53
F11-26	45
F11-27	45
F11-28	45
F11-29	45
F11-30	45
F11-31	45
F11-32	45
F11-33	45
F11-34	53
F11-35	53
F11-36	53
F11-37	53
F11-38	53
F11-39	53
F11-40	53
F11-41	64
F11-42	64

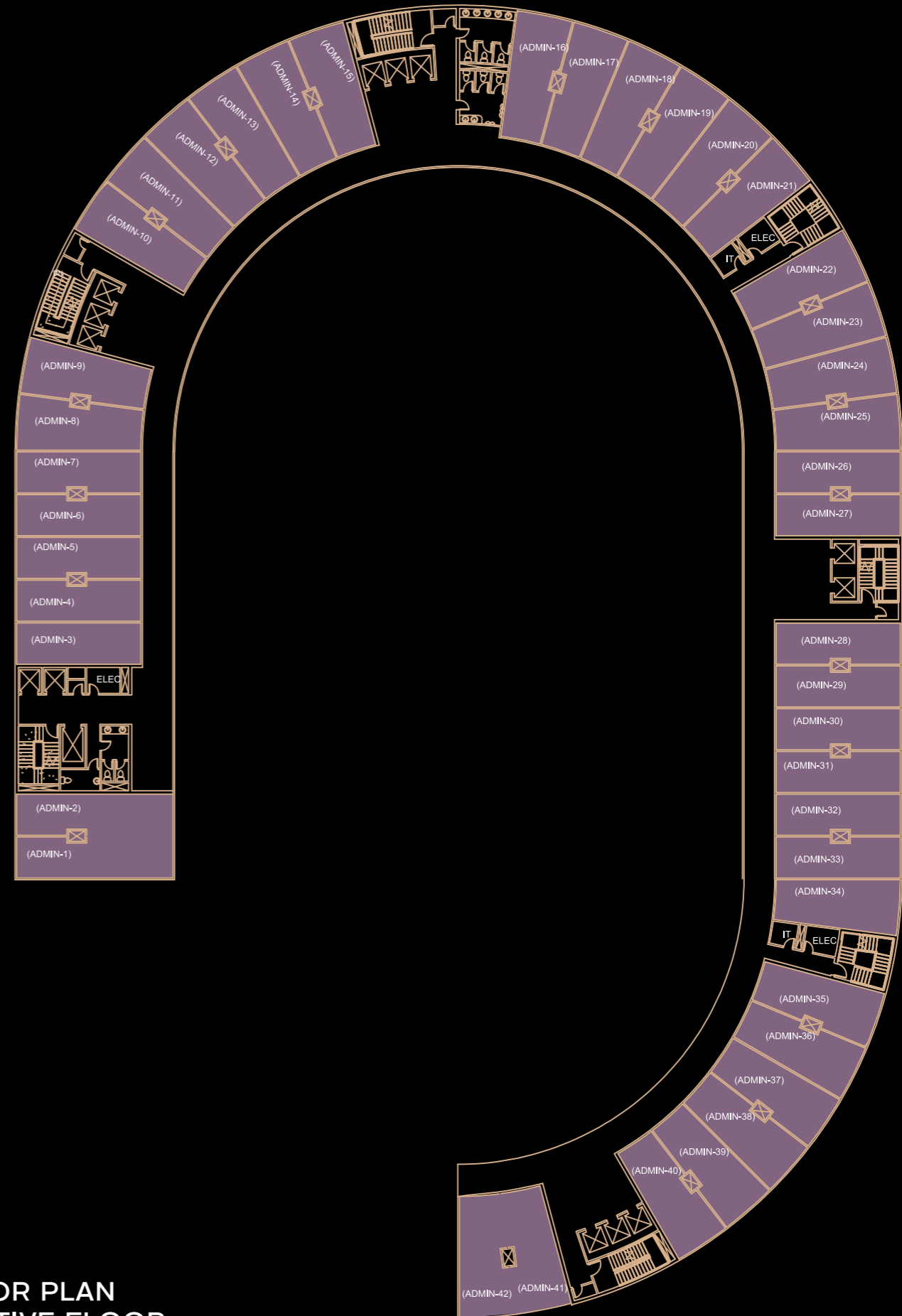

**11TH FLOOR PLAN
ADMINISTRATIVE FLOOR**

FLOOR	INDOOR
F12-1	58
F12-2	58
F12-3	44
F12-4	44
F12-5	44
F12-6	44
F12-7	44
F12-8	53
F12-9	53
F12-10	53
F12-11	53
F12-12	53
F12-13	53
F12-14	53
F12-15	53
F12-16	53
F12-17	53
F12-18	53
F12-19	53
F12-20	53

F12-21	53
F12-22	53
F12-23	53
F12-24	53
F12-25	53
F12-26	45
F12-27	45
F12-28	45
F12-29	45
F12-30	45
F12-31	45
F12-32	45
F12-33	45
F12-34	53
F12-35	53
F12-36	53
F12-37	53
F12-38	53
F12-39	53
F12-40	53

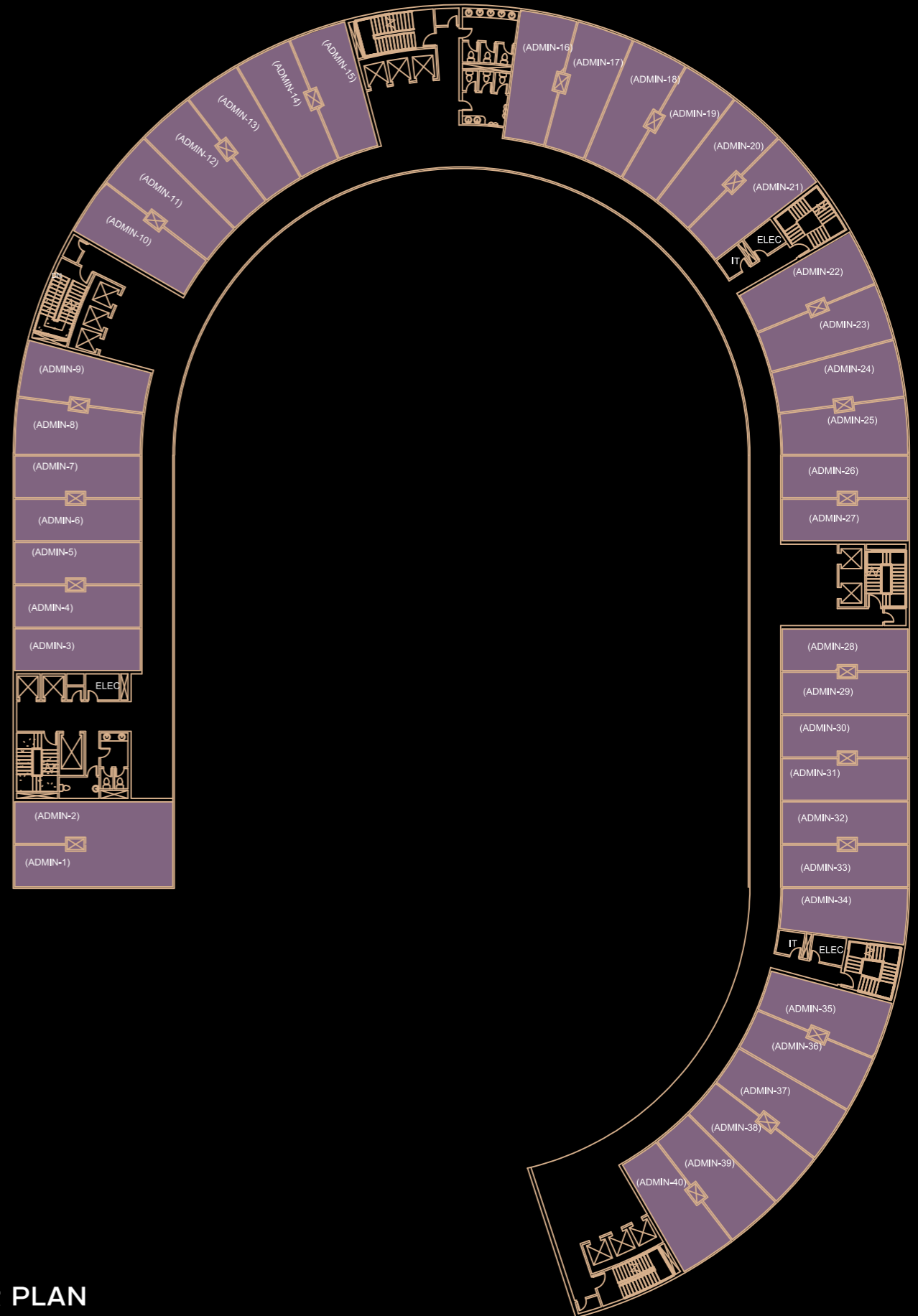

12TH FLOOR PLAN
ADMINISTRATIVE FLOOR

FLOOR	INDOOR
F13-1	58
F13-2	58
F13-3	47
F13-4	47
F13-5	47
F13-6	47
F13-7	47
F13-8	54
F13-9	54
F13-10	54
F13-11	54
F13-12	54
F13-13	54
F13-14	54
F13-15	54
F13-16	54
F13-17	54
F13-18	54
F13-19	54

F13-20	54	
F13-21	54	
F13-22	54	
F13-23	54	
F13-24	54	
F13-25	54	
F13-26	47	
F13-27	47	
F13-28	47	
F13-29	47	
F13-30	47	
F13-31	47	
F13-32	47	
F13-33	47	
F13-34	54	
F13-35	54	
F13-36	54	
F13-37	54	
F13-38	54	
F13-39	127	80

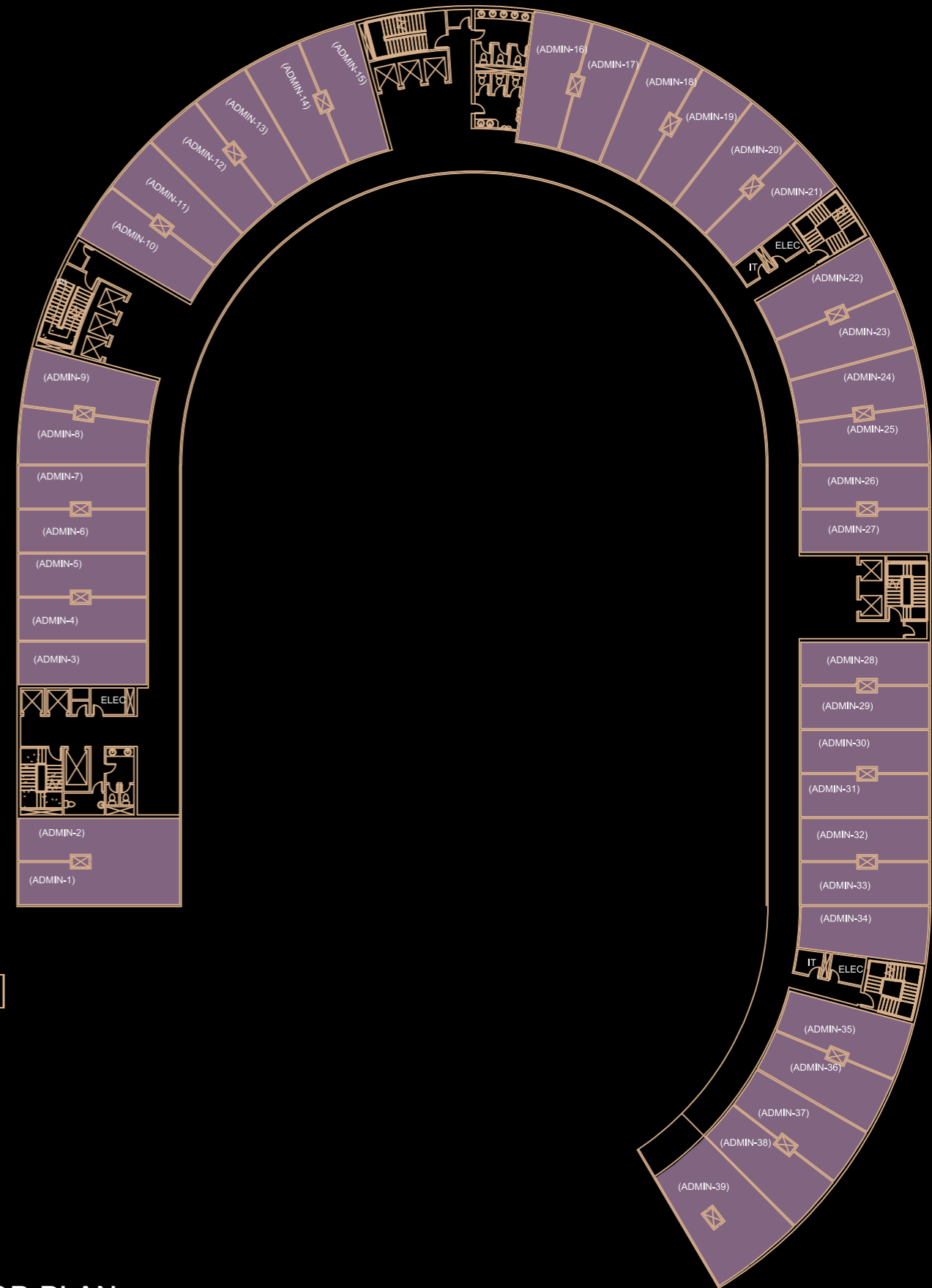

13TH FLOOR PLAN
ADMINISTRATIVE FLOOR

FLOOR	INDOOR
F14-1	58
F14-2	58
F14-3	47
F14-4	47
F14-5	47
F14-6	47
F14-7	47
F14-8	54
F14-9	54
F14-10	54
F14-11	54
F14-12	54
F14-13	54
F14-14	54
F14-15	54
F14-16	54
F14-17	54
F14-18	54
F14-19	54

F14-20	54
F14-21	54
F14-22	54
F14-23	54
F14-24	54
F14-25	54
F14-26	47
F14-27	47
F14-28	47
F14-29	47
F14-30	47
F14-31	47
F14-32	47
F14-33	47
F14-34	47
F14-35	54
F14-36	54
F14-37	64
F14-38	64
80	

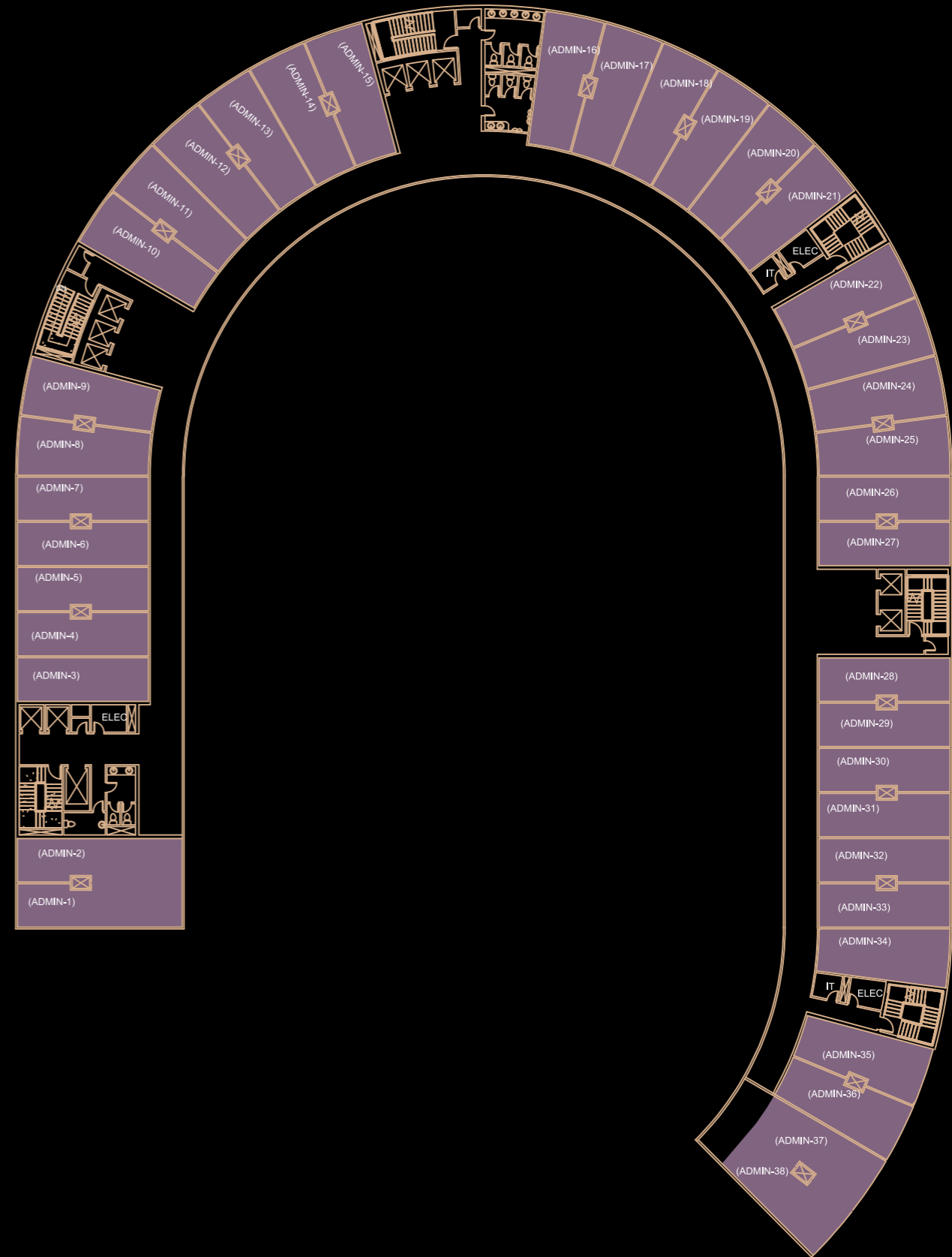

**14TH FLOOR PLAN
ADMINISTRATIVE FLOOR**

FLOOR	INDOOR
F15-1	58
F15-2	58
F15-3	47
F15-4	47
F15-5	47
F15-6	47
F15-7	47
F15-8	54
F15-9	54
F15-10	54
F15-11	54
F15-12	54
F15-13	54
F15-14	54
F15-15	54
F15-16	54
F15-17	54
F15-18	54

F15-19	54
F15-20	54
F15-21	54
F15-22	54
F15-23	54
F15-24	54
F15-25	54
F15-26	47
F15-27	47
F15-28	47
F15-29	47
F15-30	47
F15-31	47
F15-32	47
F15-33	47
F15-34	54
F15-35	64
F15-36	64
80	

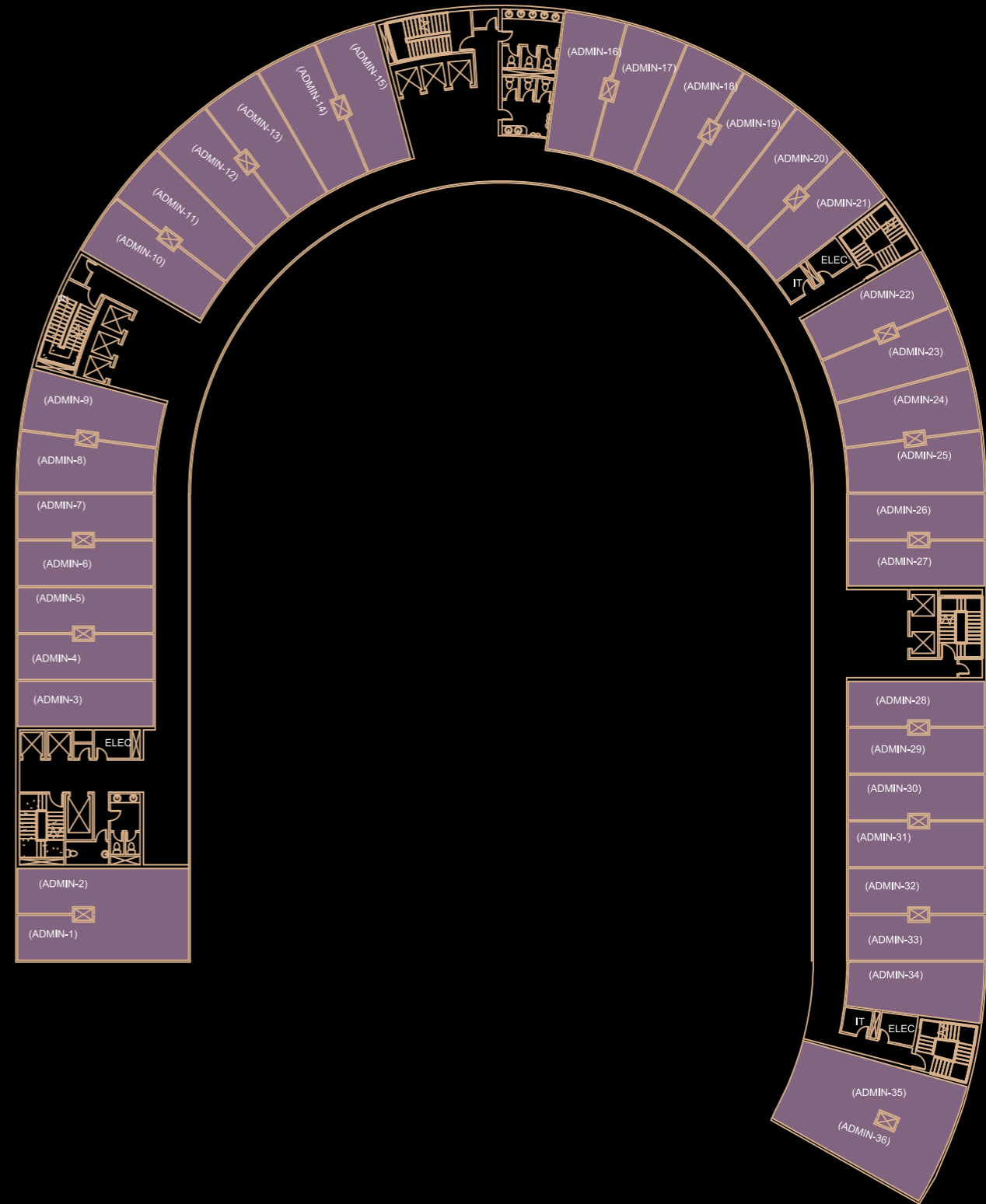

15TH FLOOR PLAN
ADMINISTRATIVE FLOOR

FLOOR	INDOOR
F17-1	58
F17-2	58
F17-3	47
F17-4	47
F17-5	47
F17-6	47
F17-7	47
F17-8	54
F17-9	54
F17-10	54
F17-11	54
F17-12	54
F17-13	54
F17-14	54
F17-15	54
F17-16	54

F17-17	54
F17-18	54
F17-19	54
F17-20	54
F17-21	54
F17-22	54
F17-23	54
F17-24	54
F17-25	54
F17-26	47
F17-27	47
F17-28	47
F17-29	47
F17-30	47
F17-31	47
F17-32	116
80	

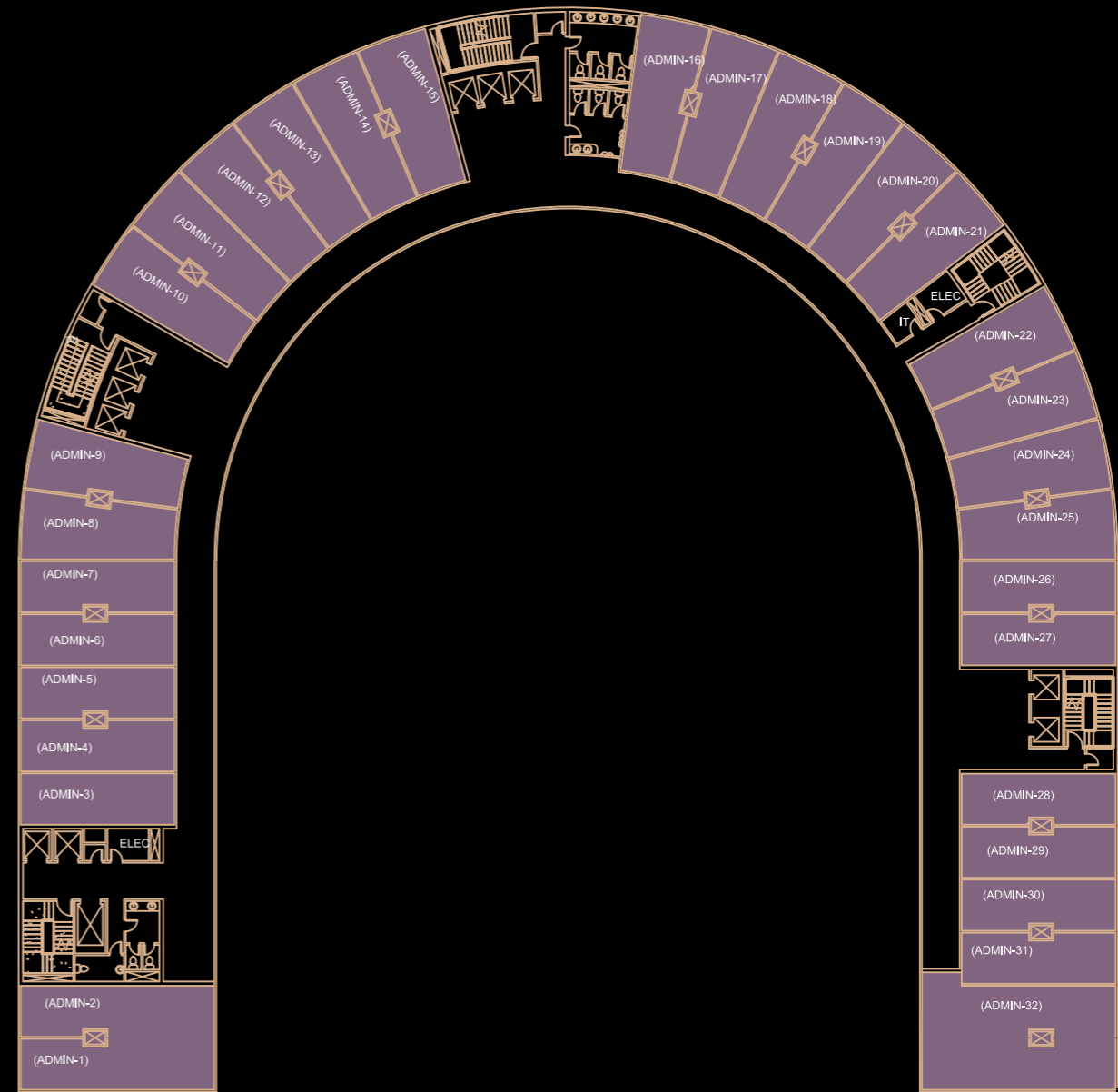

17TH FLOOR PLAN
ADMINISTRATIVE FLOOR



Simply *The Best..*

THANK
YOU

 19667

www.ucdevelop.com

    /ucdevelop